

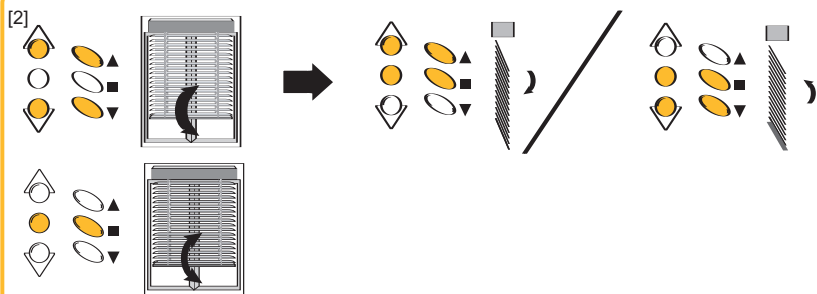

**[2]. LIGHT GAP ADJUSTMENT**

- Press the UP and DOWN buttons simultaneously until the motor jogs.
  - Press the UP and STOP or DOWN and STOP buttons until the motor jogs to adjust the gap.
  - To test the new light gap, move the shade to close position with the UP or DOWN button.
- Note: After the 3rd consecutive adjustment without testing, the amount of change factor will increase 10x.



**[3]. MOTOR DIRECTION CHANGE**

- Press the UP and DOWN buttons simultaneously until the motor jogs.
- Press the UP, STOP and DOWN buttons, for change the direction. The motor jogs.

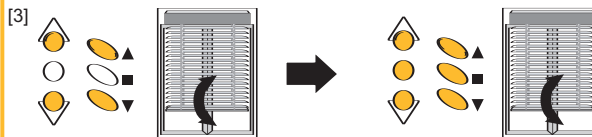

**[4]. ASSIGN A CHANNEL**

Only with the IR8 transmitter.

Note: By factory default, the motor is paired to ALL the channels on the transmitter. To designate one channel to a particular shade, the user must first delete unwanted channels (see step [5] DELETE A CHANNEL).

To enter in programming mode: Press on the transmitter prog button until the motor jogs.  
 To program one channel: press on key 1 and next on the key of the channel to program (1 to 8) or channel group until the motor jogs.  
 To exit programming mode: press on the transmitter prog button until the motor jogs.

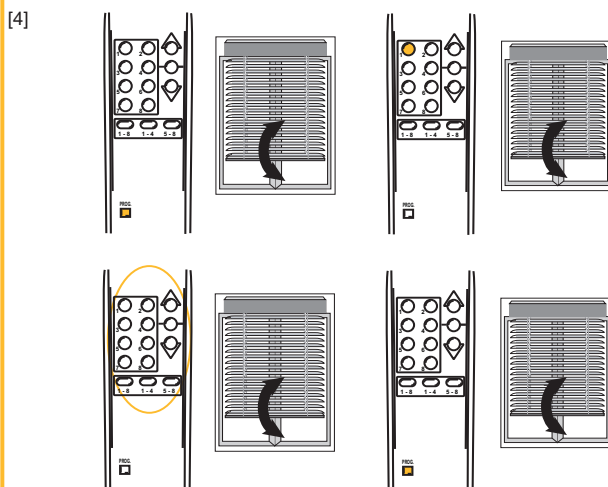

**[5].DELETE A CHANNEL**

Only with the IR8 transmitter.

To enter in programming mode: Press on the transmitter prog button until the motor jogs.  
 To erase one channel: press on key 8 and next on the key of the channel to program (1 to 8) or channel group until the motor jogs.  
 To erase all channels: press on key 8 and next on key 1->8 until the motor feedback.  
 To exit programming mode: press on the transmitter prog button until the motor jogs.

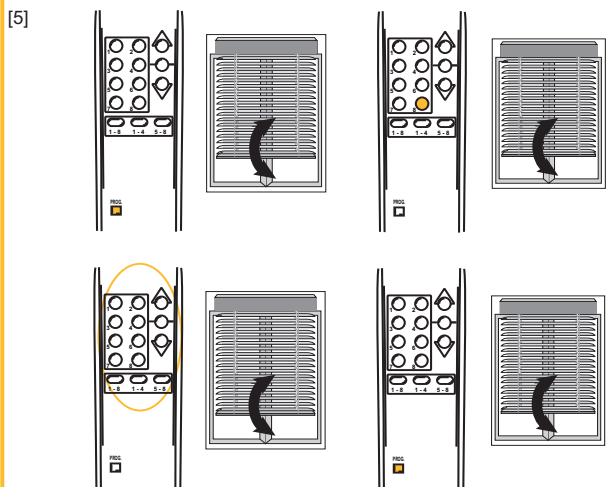

**[6].CHANNEL SELECTION**

Press 1 to 8 button. The motor jogs once the channel is paired.

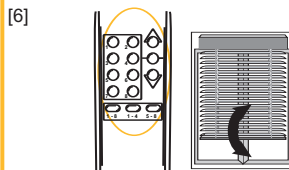

**[7]. FACTORY RESET**

- Position the blinds to be open fully (horizontal)
- With the motor prog button: Press on the motor prog button until the motor jogs 3 times. The first at 2s, the second at 7s and the third at 12s.

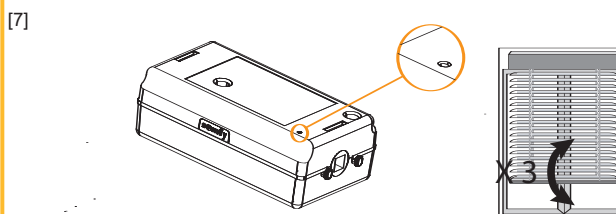

**TROUBLE SHOOTING**

<p>The motor does not work</p> <p>Verify:</p> <ul style="list-style-type: none"> <li>The batteries of the motor or of the remote control</li> <li>The compatibility of the remote control</li> </ul>	<p>The equipment stops too soon</p> <p>Verify:</p> <ul style="list-style-type: none"> <li>The batteries of the motor</li> <li>The light gap of the motor is properly adjusted</li> </ul>
--	--