

Redi Shutter™



Installation Instructions

Z Frame Inside Mount Two Panel

(Cannot be installed on walls with a windowsill)

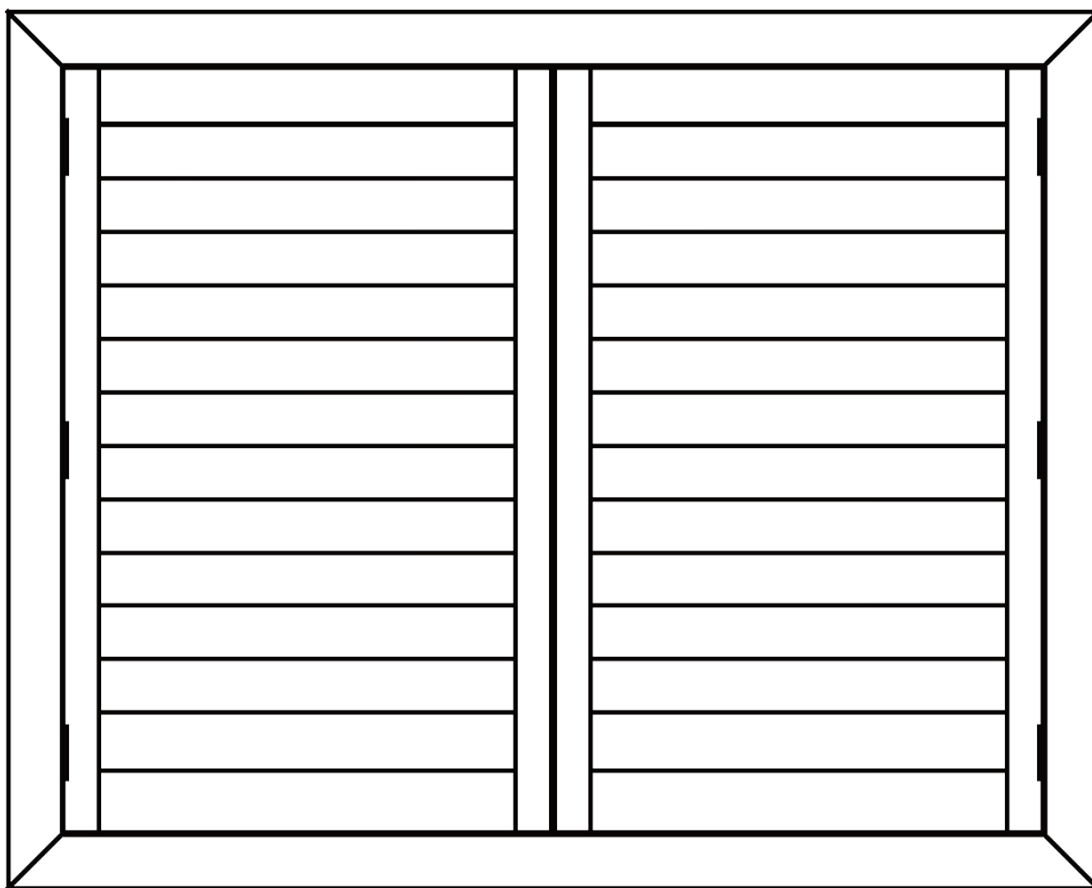

TOOLS NEEDED FOR
INSTALLING YOUR
SHUTTER

Remove the shutter from the package. Do not discard any of the packaging material until the shutter operates to your satisfaction. Check the diagram below to make sure you have the necessary parts.



Measuring
Tape

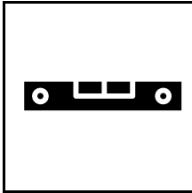

Level

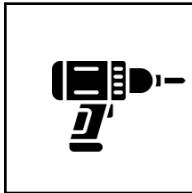

Drill



Screwdriver

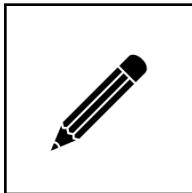

Pencil



Box Knife

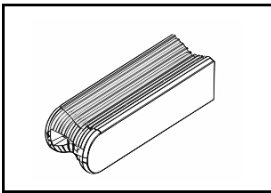

Dovetail Key

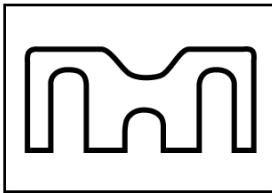

Hinge Spacers

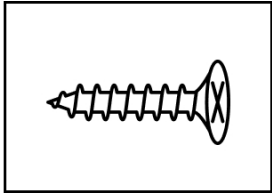

Hinge Screw

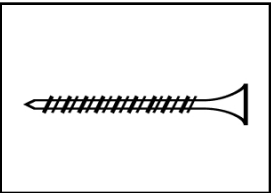

Frame Screw

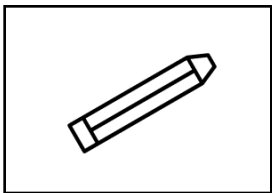

Crayon: Snow White

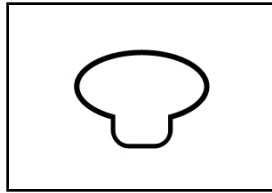

Hole Cap

Two Panel

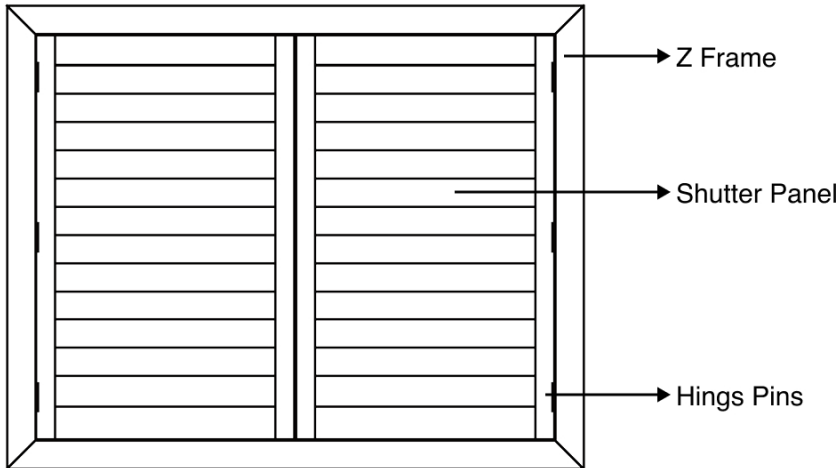

Item Number

• Item Without Frame Assemble (Step 02 to 07)

RS 4x3 RS 5x3 RS 6x3

• Item With Frame Assemble (Step 01 to 07)

RS 4x4 RS 4x5 RS 4x55
RS 4x6 RS 5x4 RS 5x5
RS 5x55 RS 5x6 RS 6x4
RS 6x5 RS 6x55 RS 6x6

01 Assemble the Frame

1) Carefully remove panels and frames from the packaging. All frame parts are labeled (top, bottom, left, and right).

2) Set all frames on a soft, level surface (moving blankets or some type of pad works best). Position each side of the frame and line up the Dovetail Key slot.

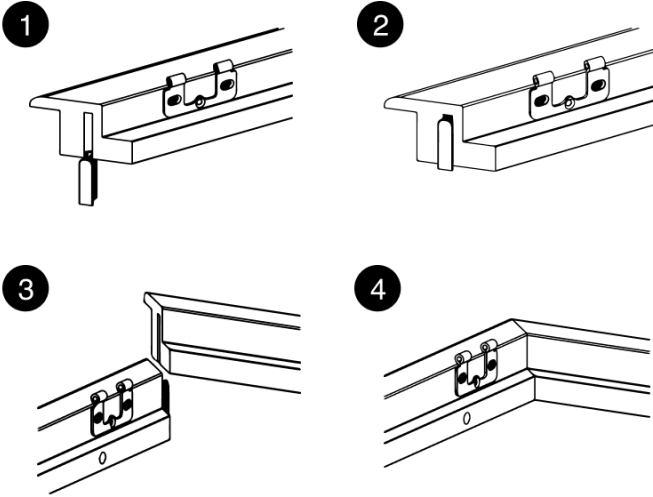
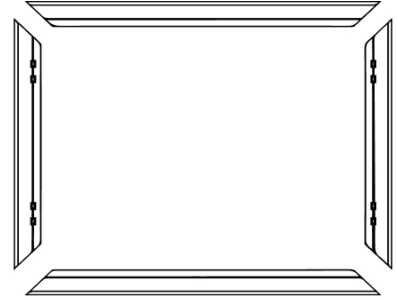

3) Insert the Dovetail Key into each slot at the back of the frame. Use a rubber mallet if necessary.



The Dovetail Key has a rounded side and a flat side. The rounded side should be inserted in slot first.



With the rounded side of the Dovetail Key facing up, push the top frame down onto the Dovetail Key.

4) The frames are pre-drilled in the top left and right frame, bottom left and right frame, and/or in the middle of each frame. Double check that all the holes are pre-drilled before placing the frame on the window.

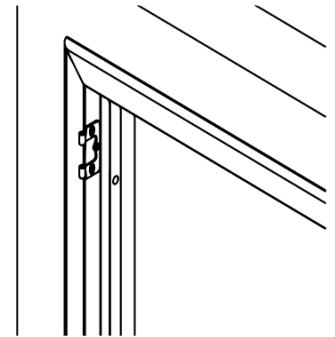

02 Level the Frame

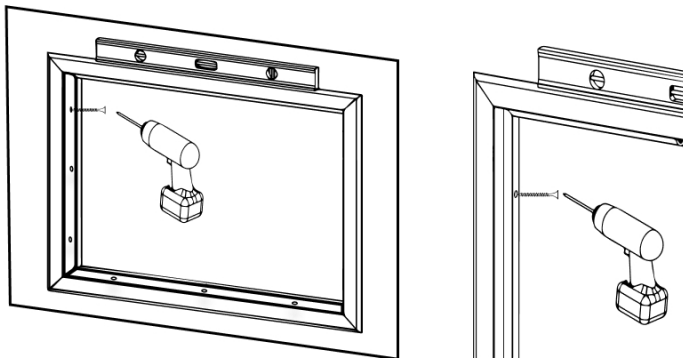

Position the assembled frame evenly along the window opening against the window. Then secure one screw into the upper left frame **ONLY**.



Secure only one screw into the upper left corner of the frame.



Place a level on top of the frame to ensure it is properly aligned with the window.

03 Secure the Frame

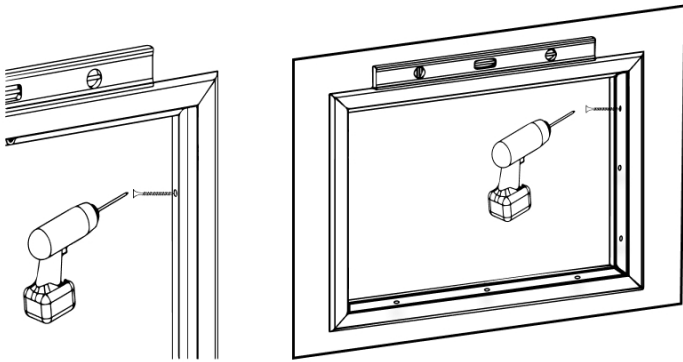

To keep the frame level, tighten one screw into the upper right frame. The shutters will be fully secured in later steps.

- ⚠ Only secure one screw into the top right frame
- ⚠ Place a level on top of the frame to ensure it is properly aligned with the window.

04 Attach the Panels

Place the left shutter panel in the frame, align the hinges, and insert the hinge pin. Repeat for the right shutter panel.

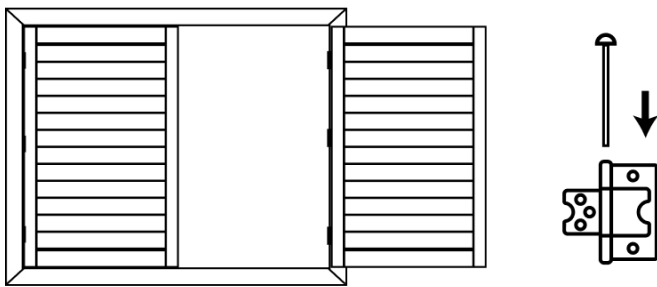

- ⚠ If you have bi-fold panels, after attaching the far left and/or far right panels to the frame, you will need to join the hinges of the panels labeled P1 and P2 and insert hinge pins.

05 Adjust Frame Hinges (Optional)

1) If panel hinges are not aligned with frame hinges properly, then frame hinges can be adjusted.

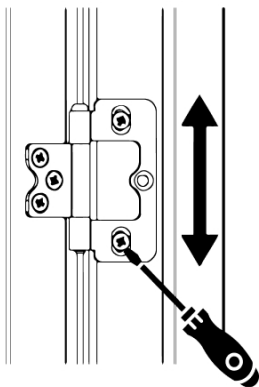

- ⚠ Loosen frame hinge screws, adjust frame hinges properly, tighten screws.

2) Please check the gap between panel and frame at the top and bottom. The gap should be even; if not, then shift frame left to right until the gap is even.

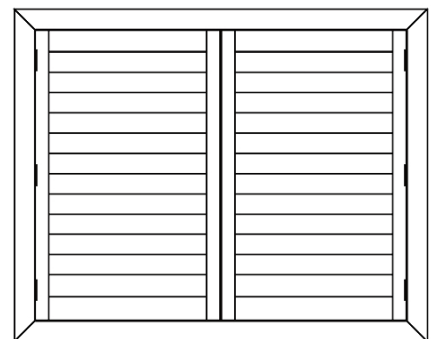

05 Adjust Frame Hinges (Optional) (Cont...)

3) Once even, secure a screw at the bottom of the left frame and right frame.

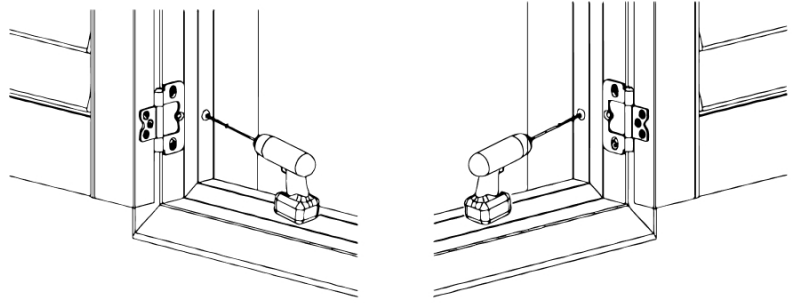

06 Adjust Panel Gaps if Necessary (Optional)

Check gap between panels and adjust accordingly with hinge spacers provided if needed.

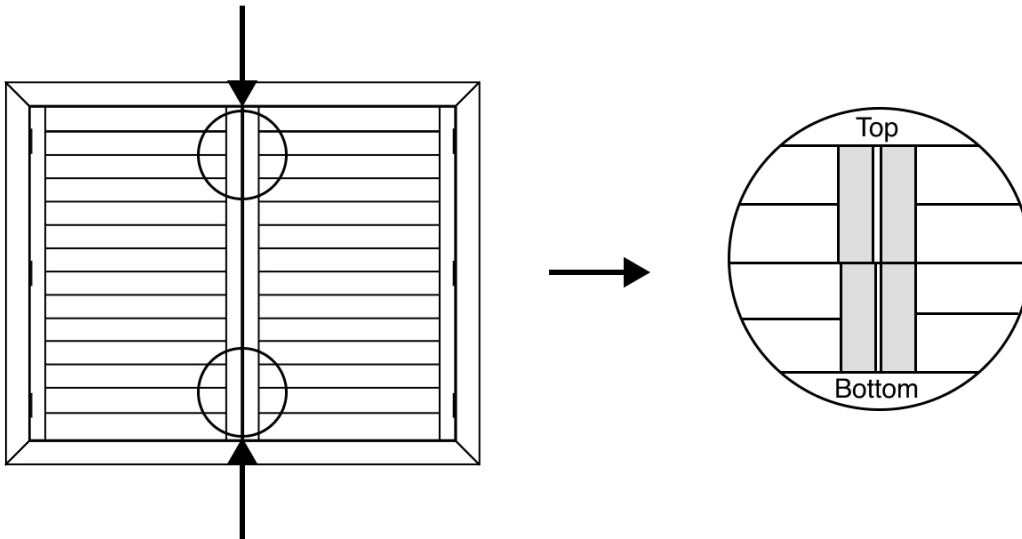

1
Loosen hinge screws on the panel

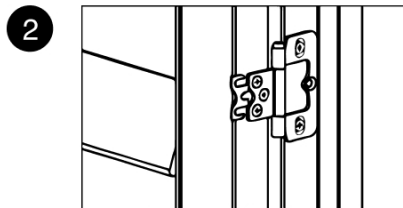

2
Insert spacer behind hinge, tighten screws

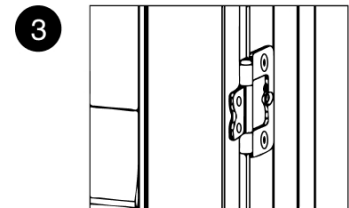

3
Spacer installed

07 Final Adjustments & Finishing Touches

1) Open and close panels to make sure panels operate properly. Secure the frame with screws through the rest of the pre-drilled holes.

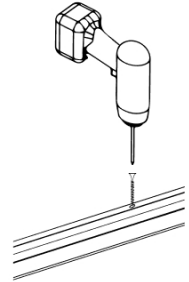
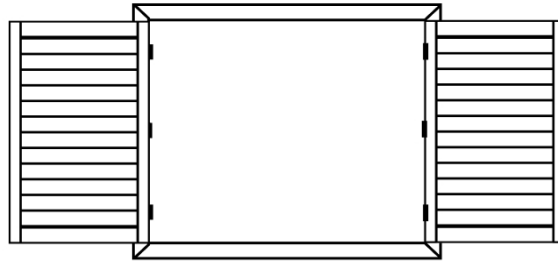
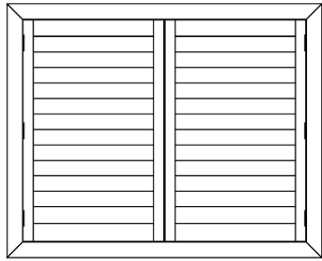

2) Install the plugs into the frame's pre-drilled plug holes to complete the look of your shutter.

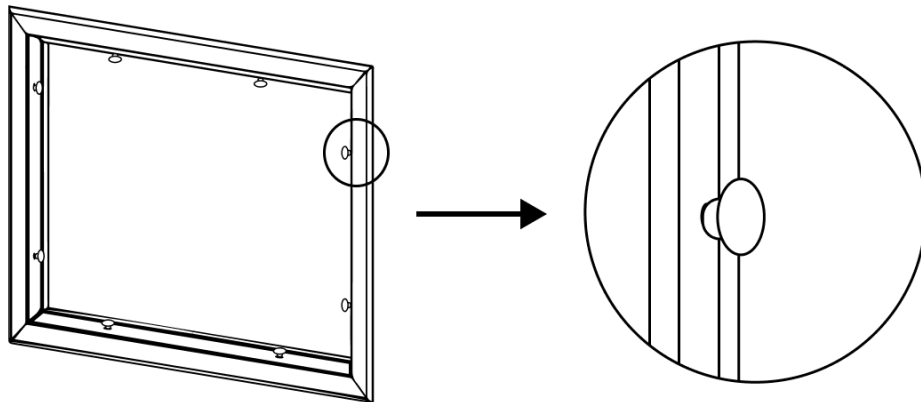

Installation complete!

Now sit back, admire your work, and enjoy your perfectly installed shutters!