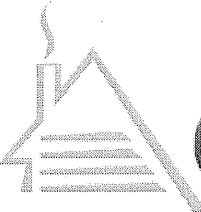

Installation
Manual

Blinds  Chalet

Valencia

**CORDLESS Roman
Shade**

INSTALLATION INSTRUCTIONS

Step 1. Check Package Contents

Mounting hardware kit includes the following:

	Part	Quantity
a	Mounting Bracket	2 (shades 18" to 47-7/8" wide) 3 (shades 48" to 60" wide) 4 (shades 60-1/8" to 72" wide)
b	1 1/8" Screws	9 (shades 18" to 47-7/8" wide) 13 (shades 48" to 60" wide) 17 (shades 60-1/8" to 72" wide)
c	Handle	1

Step 2. Tools Required

Screwdriver, tape measure, pencil, drill, step ladder.

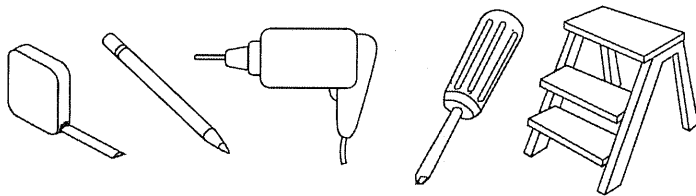

Step 3. Bracket Location and Installation

Your shade may be installed either inside the window frame or outside the window frame.

A mounting bracket should be positioned about 1" to 6" from each end of the head rail. For wider shades that require 3 or more brackets, these should be spaced evenly between the two outermost brackets. Always position the brackets such that there is no interference with the cords and mechanisms inside the head rail. The procedure outlined below will assure proper bracket placement.

For Outside Mounting:

Clip the brackets onto the head rail as described above. Hold the shade level at the height desired and center it over the window opening. Mark the exact location of each bracket with a pencil. Remove the brackets from the head rail and position the top of each bracket at the marked location and screw each bracket into the wall or window molding using the 1 1/8" screws, pre drill the screw holes using a 5/64" drill bit.

For Inside Mounting:

Clip the brackets onto the head rail as described above. Hold the shade in place and make a pencil mark at the rear of each bracket where it contacts the inside of the window frame. Remove the brackets from the head rail and align them with the marks. Attach each bracket using the 1 1/8" screws, pre drill the screw holes using a 5/64" drill bit.

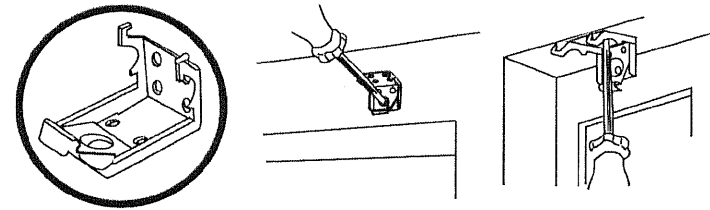

Step 4. Securing the Head Rail

Lift the head rail into position such that the front edge of each bracket is under the inner front edge of the head rail. Push the head rail upward until the flexible tab at the bottom of each bracket snaps onto the back of the head rail. Check carefully to assure that each bracket is properly secured.

Step 5. Attach Handle / How to Operate

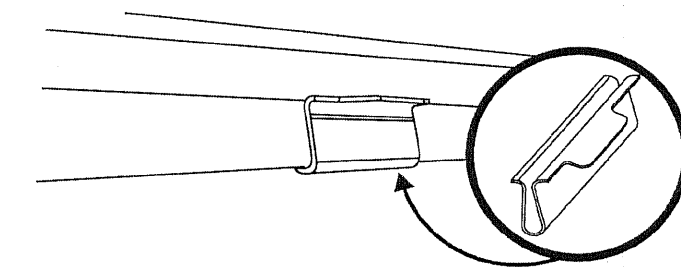

Attach the handle to the bottom of the shade as illustrated. The handle is designed to minimize contact with the shade fabric. Always raise and lower the shade slowly to assure that the fabric gathers neatly.

To lower the shade: grip the handle and slowly pull straight down.

To raise the shade: put one hand under the handle (palm facing up) and lift slowly until the desired height is reached.

CLEANING YOUR SHADES

To clean the shade fabric, use a feather duster or vacuum lightly using the soft brush attachment. If heavy cleaning is required, please consult a professional drapery cleaning service.

REPLACEMENT PARTS

In the event that replacement parts are ever needed, you may call : 1-888-633-7840

Please provide original order # and description of the part needed.

ONE YEAR LIMITED WARRANTY

I. What is warranted and for how long :

For a period of one(1) year from the date of purchase.

Blindschalet.com will replace this window covering with one of equal or superior value, if this window covering is found to be defective in material or workmanship.

II. What is not covered by this Warranty:

This warranty does not cover removal or installation of any window covering.

This Warranty does not cover damage or defects caused by or resulting from improper maintenance, negligent or improper use, abuse, misuse, neglect, accidents, act of God, alteration, commercial use, installation, removal or reinstallation.

This Warranty is restricted to normal consumer use within the United States.

BLINDSCHALET.COM WILL NOT BE LIABLE FOR INCIDENTAL OR CONSEQUENTIAL DAMAGES, SOME STATES DO NOT ALLOW THE EXCLUSION OR LIMITATION OF INCIDENTAL OR CONCEQUENTIAL DAMAGES, SO THE ABOVE LIMITATION OR EXCLUSION MAY NOT APPLY TO YOU.

III. How to obtain warranty service:

To obtain warranty service, please contact Customer Service at #1-888-633-7840 or via e-mail at customerservice@blindschalet.com

WARNING



Inner cords can pull out to form a loop, which can STRANGLE a young child.

Children can climb furniture to access inner cords. Move cribs, playpens, and other furniture away from window coverings.