

Cellular and Pleated Shade Installation Instructions

3/8" Single and Double Cell - Inside, Ceiling & Outside Mount

3/4" Single Cell - Inside, Ceiling & Outside Mount

Top-Down / Bottom-Up, Cordless, Cordless and Top-Down / Bottom Up

Motorized

Thank you for choosing Springs Window Fashions. Your blind has been custom-sized based on your specifications with the highest standards of quality and craftsmanship.

Follow the easy step-by-step instructions to install your blind. Should you need additional support, please feel free to call our Customer Service Center at 1-800-221-6352 or email us at windowfashions@springswindowfashions.com. We will be glad to help you.

For additional safety information in Canada, contact 1-866-662-0666.

Gracias por elegir Springs Window Fashions. Su persiana se ha confeccionado a la medida según sus especificaciones y con los estándares más altos de calidad y fabricación.

Siga las sencillas instrucciones detalladas para instalar su persiana. Si necesita asistencia adicional, comuníquese con nuestro Centro de servicio al cliente al 1-800-221-6352 o por correo electrónico a windowfashions@springswindowfashions.com. Será un gusto poder ayudarlo.

Para información adicional en Canadá sobre seguridad, llamar al 1-866-662-0666.

Merci d'avoir choisi Springs Window Fashions. Votre store a été taillé sur mesure selon vos spécifications avec les normes les plus élevées de qualité et de fabrication.

Suivez les directives étape par étape faciles pour installer votre store. Si vous avez besoin d'aide supplémentaire, n'hésitez pas à communiquer avec notre centre de service à la clientèle au 1-800-221-6352 ou envoyez-nous un courriel à windowfashions@springswindowfashions.com.

Nous serons heureux de vous aider.

Pour de plus amples informations sur la sécurité au Canada, appelez le 1-866-662-0666.



Finished looks
Apariencia final
Aspects finis

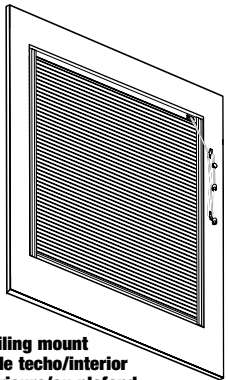

Inside/ceiling mount
Montaje de techo/interior
Pose intérieure/au plafond

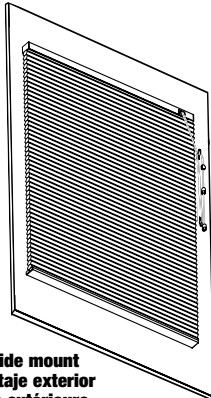

Outside mount
Montaje exterior
Pose extérieure

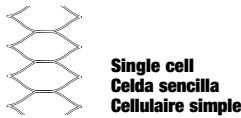

Single cell
Celda sencilla
Cellulaire simple

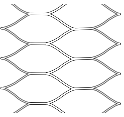

Double cell
Celda doble
Cellulaire double



Pleated
Plisada
Plissé

HOW TO INSTALL Inside-/ceiling- or outside-mount cellular or pleated standard shade

CÓMO INSTALAR Montaje de techo/interior o montaje exterior de la persiana de tela celular o plisada estándar

COMMENT INSTALLER Store traditionnel à pose intérieure/au plafond ou extérieure

SPRINGS WINDOW FASHIONS
the Best Experience Company

Springs Window Fashions • Middleton, WI 53562-1096 • www.springswindowfashions.com

78138-03 (01/15)

1

Everything needed to install your shade
Todo lo necesario para instalar su persiana
Tout le nécessaire pour installer votre store

- 1 Shade
- 2 Brackets/screws
- 3 Cord cleats
- 4 Optional hold-down brackets
- 5 Optional extension brackets
- 6 Optional side-mount brackets

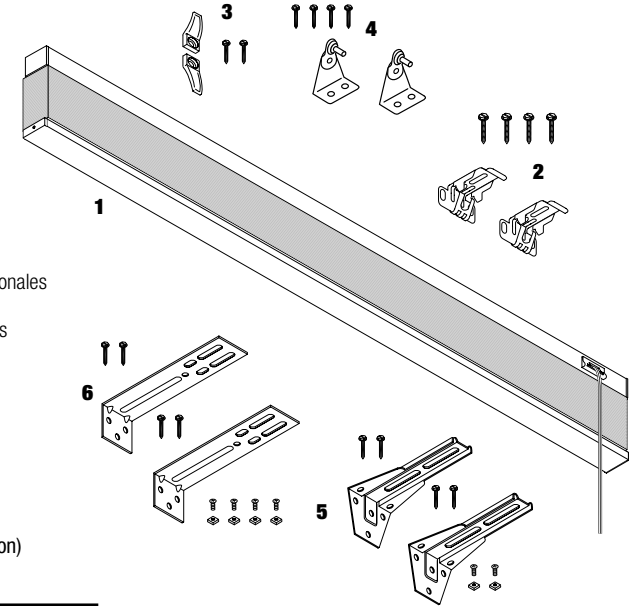

- 1 Persiana
- 2 Soportes/tornillos
- 3 Sostenedores de cuerda
- 4 Soportes sostenedores inferiores opcionales
- 5 Soportes de extensión opcionales
- 6 Soportes de montaje lateral opcionales
- 7 Abrazadera para cordón

- 1 Store
- 2 Supports/vis
- 3 Taquets du cordon
- 4 Supports de retenue (en option)
- 5 Rallonges (en option)
- 6 Supports pour pose latérale (en option)
- 7 Taquet à cordon

Bracket chart Tabla de soportes Tableau des supports		
Ordered width Ancho ordenado Largeur commandée		Bracket quantity Cantidad de soportes Quantité de boîtier
≤ 42"	≤ 106,7 cm	2
≤ 70"	≤ 177,8 cm	3
≤ 96"	≤ 243,8 cm	4
≤ 120"	≤ 305 cm	5
≤ 150"	≤ 381 cm	6
≤ 170"	≤ 431,8 cm	7
≤ 192"	≤ 487,7 cm	8

AngleTop chart Tabla de AngleTop Tableau de AngleTop		
Angle width (AngleTop Only) Ángulo ancho (Sólo AngleTop) Largeur Angle (AngleTop Uniquement)		Bracket quantity Cantidad de soportes Quantité de boîtier
≤ 20"	≤ 50,8 cm	3
≤ 42"	≤ 106,7 cm	4
≤ 70"	≤ 177,8 cm	5
≤ 84"	≤ 213,4 cm	6
≤ 90"	≤ 228,6 cm	7

Tools needed • Herramientas necesarias • Outillage nécessaire

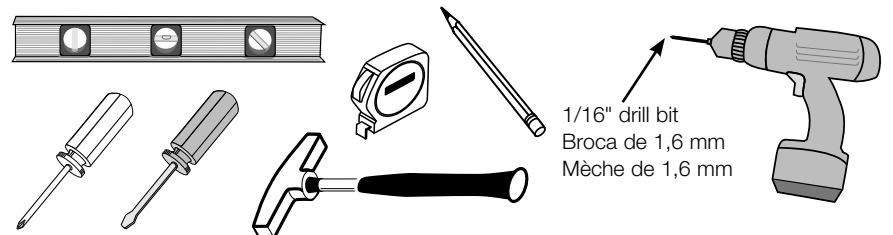

1/16" drill bit
Broca de 1,6 mm
Mèche de 1,6 mm

2

Determine inside/ceiling, outside or side mount
 Determine el montaje de techo/interior, exterior o montaje lateral
 Choisir la pose intérieure/au plafond, extérieure ou latérale

2

Optional side mount for shades 60" or less: assemble brackets
 Montaje lateral opcional para persianas de 152,4 cm o menores:
 ensamble los soportes
 Pose latérale en option pour stores de 152,4 cm ou moins : assembler les supports

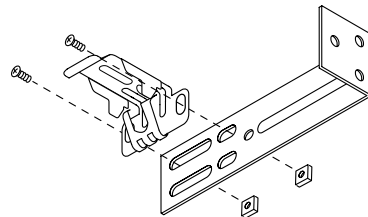
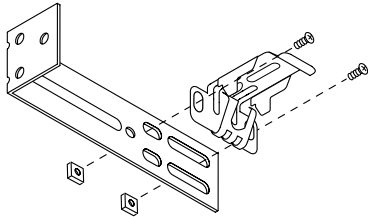
**3**

Place shade in desired location, mark corners
 Coloque la persiana en la ubicación deseada, marque las esquinas
 Placer le store dans l'emplacement souhaité, marquer les coins

Inside/ceiling mount
 Montaje de techo/interior • Pose intérieure/au plafond

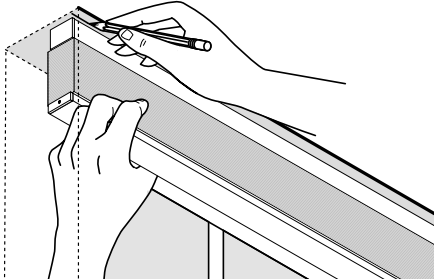

Outside mount
 Montaje exterior • Pose extérieure

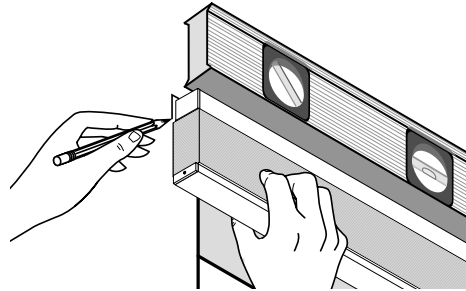

Optional side mount
 Montaje lateral opcional • Pose latérale (en option)

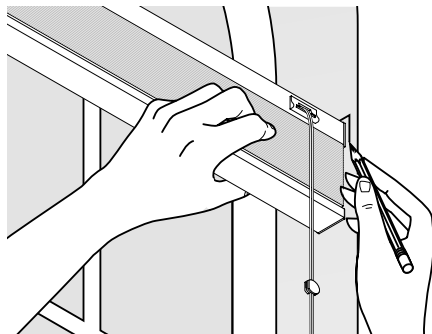
**4**

Measure in from shade edge on both ends and mark
 Mida desde el borde de la persiana en ambos extremos y marque
 Mesurer depuis le bord du store à chaque extrémité, et marquer

Inside/ceiling mount
 Montaje de techo/interior • Pose intérieure/au plafond

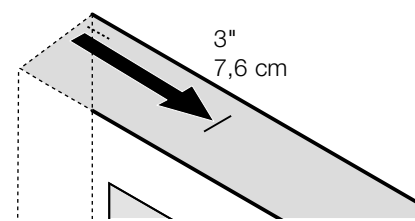

Outside mount
 Montaje exterior • Pose extérieure

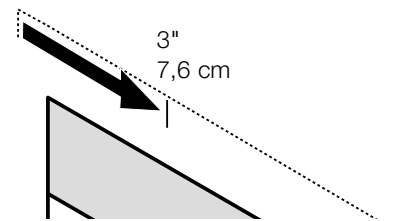
**5**

Mark screw locations; center additional brackets, if applicable
 Marque la ubicación de los tornillos; centre los soportes adicionales, si es aplicable
 Marquer l'emplacement des vis ; centrer les supports supplémentaires, le cas échéant

Inside/ceiling mount
 Montaje de techo/interior • Pose intérieure/au plafond

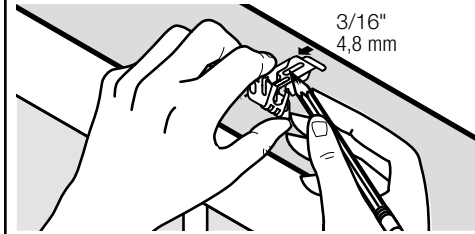

3/16" to front of bracket for flush mount
 4,8 mm desde el frente del soporte para un montaje a ras
 4,8 mm jusqu'à l'avant du support pour montage encastré

Outside mount
 Montaje exterior • Pose extérieure

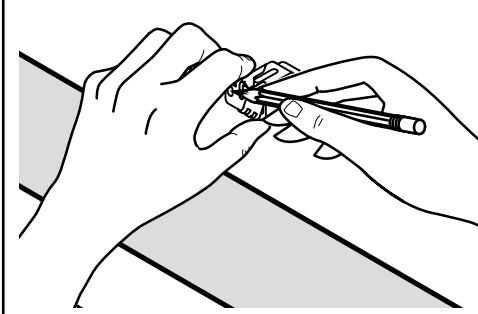

Optional side mount
 Montaje lateral opcional • Pose latérale (en option)

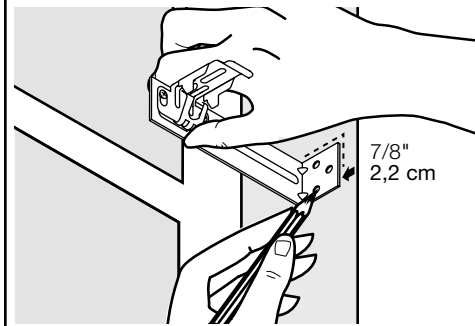

7/8" to front of bracket for flush mount
 2,2 cm desde el frente del soporte para un montaje a ras
 2,2 cm jusqu'à l'avant du support pour montage encastré

Optional extension bracket
 Soporte de extensión opcional • Rallonge (en option)

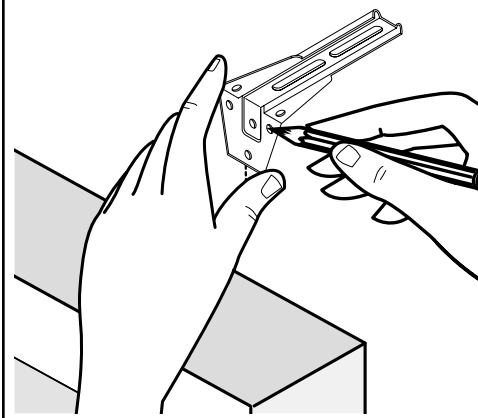

6

Drill holes
Taladre los agujeros
Percer les trous

Inside/ceiling mount
Montaje de techo/interior • Pose intérieure/au plafond

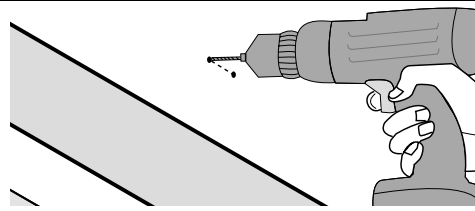
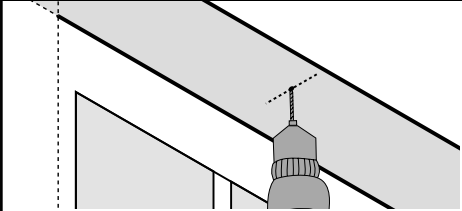

Optional side mount
Montaje lateral opcional • Pose latérale (en option)

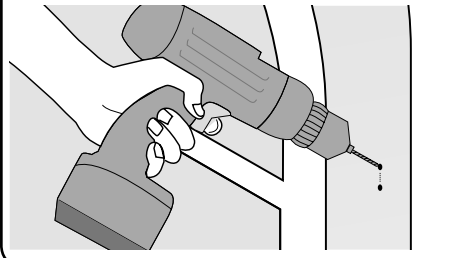

Optional extension bracket
Soporte de extensión opcional • Rallonge (en option)

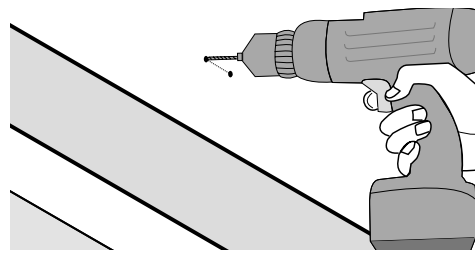

7

Screw brackets into place
Atornille los soportes en su lugar
Visser les supports

Inside/ceiling mount
Montaje de techo/interior • Pose intérieure/au plafond

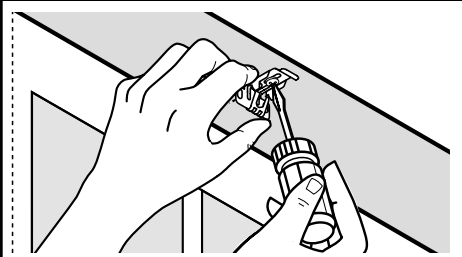

Outside mount
Montaje exterior • Pose extérieure

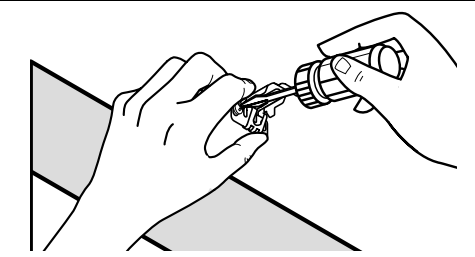

Optional side mount
Montaje lateral opcional • Pose latérale (en option)

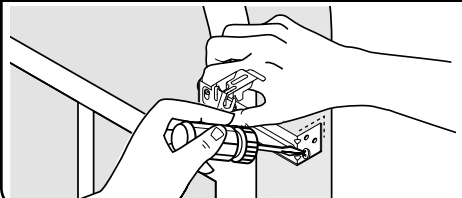

Optional extension bracket
Soporte de extensión opcional • Rallonge (en option)

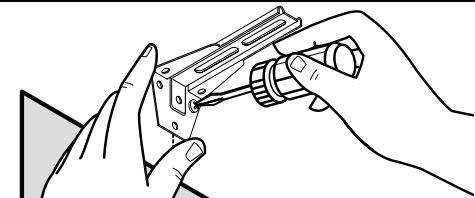

7

Optional extension brackets: assemble brackets
Soportes de extensión opcionales: ensamble los soportes
Rallonges en option : assembler les supports

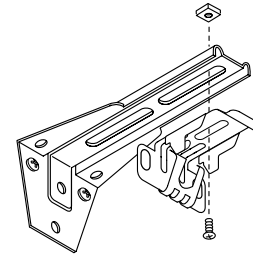

Attach headrail brackets to extension brackets using machine screws and nuts.
Conecte los soportes del cabezal a los soportes de extensión usando tornillos y tuercas.
Fixer les supports de boîtier aux rallonges à l'aide des vis et boulons de mécanique.

8

Mount shade into brackets
Monte la persiana en los soportes
Monter le store sur les supports

Inside/ceiling mount
Montaje de techo/interior • Pose intérieure/au plafond

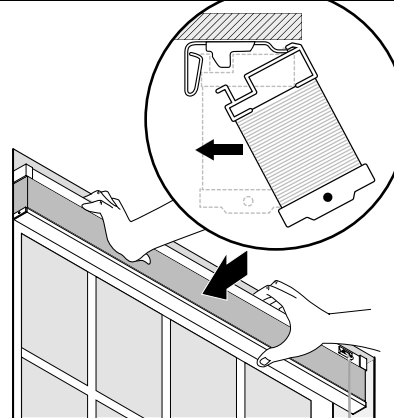

Outside mount
Montaje exterior • Pose extérieure

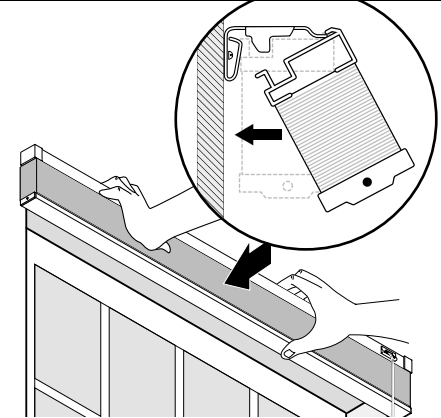

Optional side mount
Montaje lateral opcional • Pose latérale (en option)

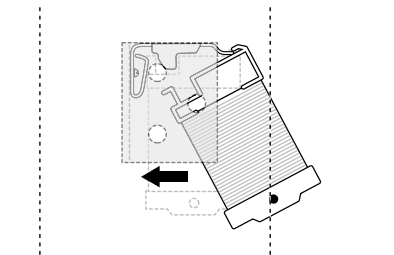

Optional extension bracket
Soporte de extensión opcional • Rallonge (en option)

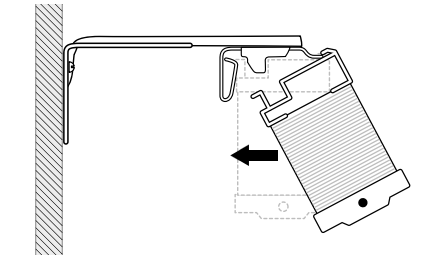

9

Important shade operating information: cord cleats
Importante información para la operación de la persiana: sostenedores de cuerda
Information importante relative à l'emploi du store : taquets de cordon

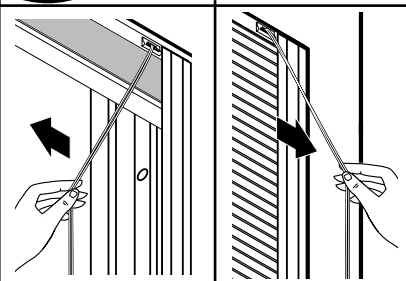

Pull the cords toward the center to lower shade to desired position. Pull toward the outside edge to lock the shade.

Jale las cuerdas hacia el centro para bajar la persiana a la más baja posición deseada. Jale hacia el borde exterior para trabar la persiana.

Tirer les cordons vers le centre pour baisser le store dans la position désirée la plus basse. Tirer vers l'extérieur pour bloquer le store.

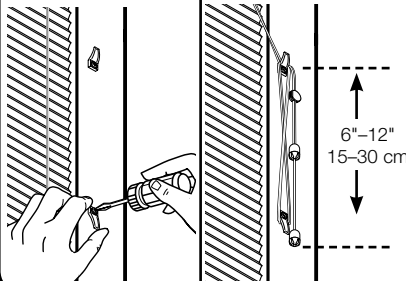

Install cord cleats and wrap cords in a figure eight to secure.

Instale los sostenedores de la cuerda; amarre las cuerdas en la forma de un ocho para asegurarla.

Installer les taquets du cordon ; enrouler les cordons en 8 pour les arrimer.



Optional: mount hold-down brackets
Opcional: monte los soportes para los sostenedores inferiores
En option: installer les supports de retenue

Inside/ceiling mount
Montaje de techo/interior • Pose intérieure/au plafond



Outside mount
Montaje exterior • Pose extérieure

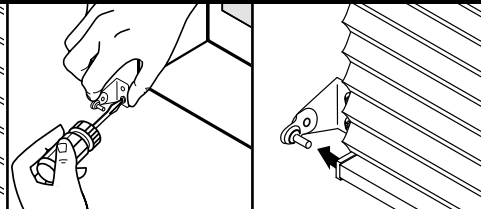

Inside/ceiling mount for pleated shade
Montaje de techo/interior • Pose intérieure/au plafond

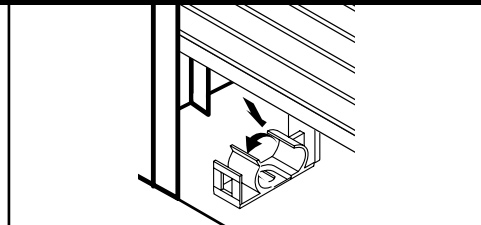
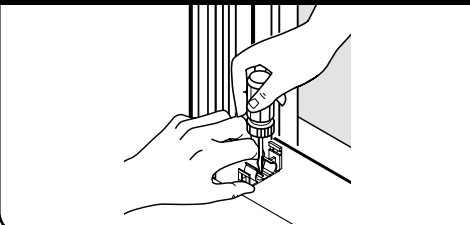

Cellular shade length adjustment
Ajuste de la longitud de la persiana de tela celular
Réglage de la longueur des stores cellulaires

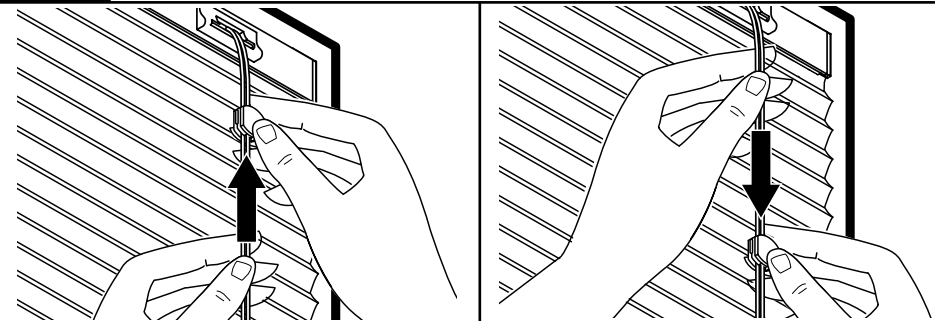

If Cellular Shade length adjustment is necessary, allow to hang for 24 hours at full extension. To adjust shade, firmly hold cords and slide snap tassel up to shorten or down to lengthen.

Si se necesita un ajuste de la longitud de la persiana de tela celular, permita que cuelgue por 24 horas totalmente extendida. Para ajustar la persiana, sostenga firmemente las cuerdas y deslice las borlas para acortar o baje para alargar.

Si un réglage de la longueur du store s'avère nécessaire, le laisser pendre en pleine extension pendant 24 heures. Pour régler le store, tenir les cordons fermement et faire glisser le gland pression vers le haut pour raccourcir ou vers le bas pour allonger.



Shade removal
Remoción de la persiana
Enlèvement du store

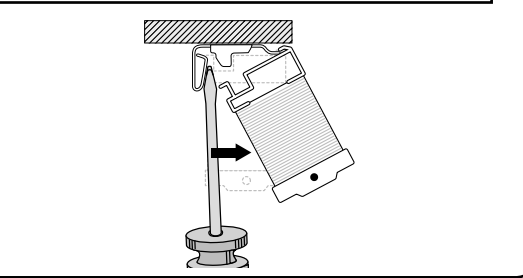
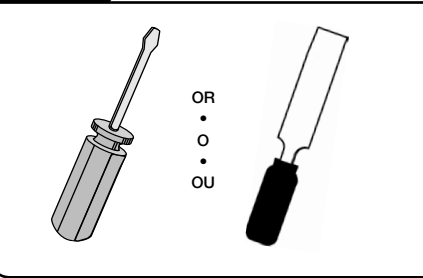

Clientes de México: llamar al 01-800-909-0793 para obtener instrucciones sobre el lugar al que deben enviar el producto para su reparación.
 Importador en México:
 Springs Window Fashions Sales Company de México, S. de R.L. de C.V.
 Carretera Federal Reynosa a Matamoros Sin Número Edif 10 A
 Prologis Park, Ciudad Reynosa, Tamaulipas CP 88780
 TEL. (899) 954-0361

Customers located in the USA and Canada:
 Contact our Customer Service Center at 1-800-221-6352
 Springs Window Fashions LLC
 8467 Route 405 South, P.O. Box 500
 Montgomery, PA 17752

SPRINGS WINDOW FASHIONS
 the Best Experience Company

Springs Window Fashions • Middleton, WI 53562-1096 • www.springswindowfashions.com

78138-03 (01/15)

Thank you for choosing Springs Window Fashions. Your shade has been custom-sized based on your specifications with the highest standards of quality and craftsmanship.

Follow the easy step-by-step instructions to install your shade. Should you need additional support, please feel free to call our Customer Service Center at 1-800-221-6352 or email us at windowfashions@springswindowfashions.com. We will be glad to help you.

For additional safety information in Canada, contact 1-866-662-0666.

Gracias por elegir Springs Window Fashions. Su persiana se ha confeccionado a la medida según sus especificaciones y con los estándares más altos de calidad y fabricación.

Siga las sencillas instrucciones detalladas para instalar su persiana. Si necesita asistencia adicional, comuníquese con nuestro Centro de servicio al cliente al 1-800-221-6352 o por correo electrónico a windowfashions@springswindowfashions.com. Será un gusto poder ayudarlo.

Para información adicional en Canadá sobre seguridad, llamar al 1-866-662-0666.

Merci d'avoir choisi Springs Window Fashions. Votre store a été taillé sur mesure selon vos spécifications avec les normes les plus élevées de qualité et de fabrication.

Suivez les directives étape par étape faciles pour installer votre store. Si vous avez besoin d'aide supplémentaire, n'hésitez pas à communiquer avec notre centre de service à la clientèle au 1-800-221-6352 ou envoyez-nous un courriel à windowfashions@springswindowfashions.com. Nous serons heureux de vous aider.

Pour de plus amples informations sur la sécurité au Canada, appelez le 1-866-662-0666.



Finished Looks
Apariencia final
Aspects finis

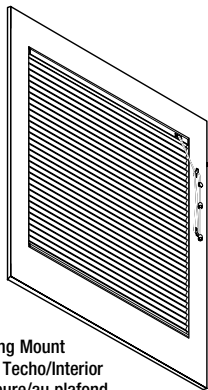

Inside/Ceiling Mount
Montaje de Techo/Interior
Pose intérieure/au plafond

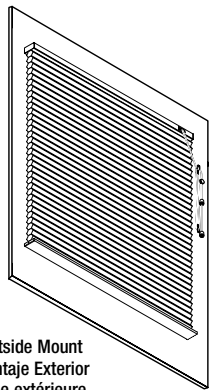

Outside Mount
Montaje Exterior
Pose extérieure

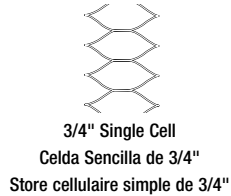

3/4" Single Cell
Celda Sencilla de 3/4"
Store cellulaire simple de 3/4"



Pleated
Plisada
Plissé

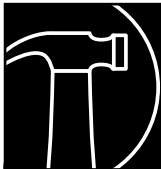

HOW TO INSTALL
CÓMO INSTALAR
COMMENT INSTALLER

Inside-/Ceiling- or Outside-mount Cellular or Pleated Standard Shade
Montaje de Techo/Interior o Montaje Exterior de la Persiana Estándar
Store standard plissé ou cellulaire à montage intérieur/au plafond ou extérieur

1

Everything needed to install your shade
Todo lo necesario para instalar su persiana.
Tout le nécessaire pour installer votre store

- 1 Shade
- 2 Brackets/Screws
- 3 Cord Cleats
- 4 Optional Hold-down Brackets
- 5 Optional Extension Brackets
- 6 Optional Side-mount Brackets

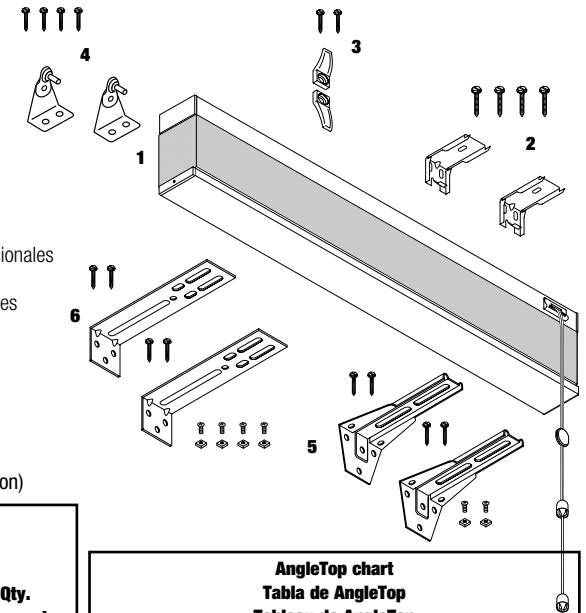

- 1 Persiana
- 2 Soportes/Tornillos
- 3 Sostenedores de Cuerda
- 4 Soportes Sostenedores Inferiores Opcionales
- 5 Soportes de Extensión Opcionales
- 6 Soportes de Montaje Lateral Opcionales

- 1 Store
- 2 Supports/Vis
- 3 Taquets du cordon
- 4 Supports de retenue (en option)
- 5 Rallonges (en option)
- 6 Supports pour pose latérale (en option)

Bracket Chart Tabla de Soportes Tableau des supports		
Ordered Width Ancho ordenado Largeur commandée		Bracket Qty. Cantidad de soportes Quantité de boîtier
≤ 42"	106,7cm	2
≤ 70"	177,8cm	3
≤ 96"	243,8cm	4
≤ 120"	304,8cm	5
≤ 150"	381,0cm	6
≤ 170"	431,8cm	7
≤ 192"	487,7cm	8

AngleTop chart Tabla de AngleTop Tableau de AngleTop		
Angle width (AngleTop Only) Ángulo ancho (Sólo AngleTop) Largeur Angle (AngleTop Uniquement)		Bracket quantity Cantidad de soportes Quantité de boîtier
≤ 20"	≤ 50,8 cm	3
≤ 42"	≤ 106,7 cm	4
≤ 70"	≤ 177,8 cm	5
≤ 84"	≤ 213,4 cm	6
≤ 90"	≤ 228,6 cm	7

Tools Needed • Herramientas Necesarias • Outillage Nécessaire

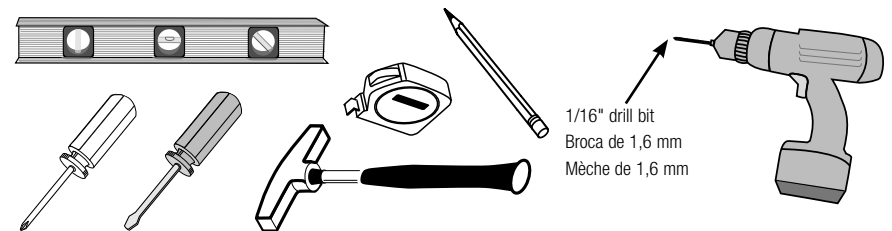

SPRINGS WINDOW FASHIONS
the Best Experience Company

2

Determine inside/ceiling, outside or side mount
 Determine el montaje de techo/interior, exterior o montaje lateral
 Choisir la pose intérieure/au plafond, extérieure ou latérale

2

Optional side mount for shades 60" or less: assemble brackets
 Montaje lateral opcional para persianas de 152,4 cm o menores: ensamble los soportes
 Pose latérale en option pour stores de 152,4 cm ou moins : assembler les supportssupports

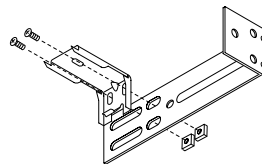
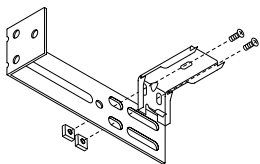
**3**

Place shade in desired location, mark corners
 Coloque la persiana en la ubicación deseada, marque las esquinas
 Placer le store dans l'emplacement souhaité, marquer les coins

Inside/Ceiling Mount
 Montaje de Techo/Interior • Pose intérieure

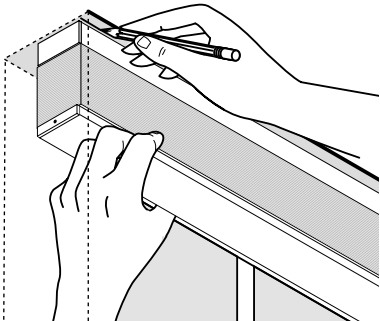

Outside Mount
 Montaje Exterior • Pose extérieure

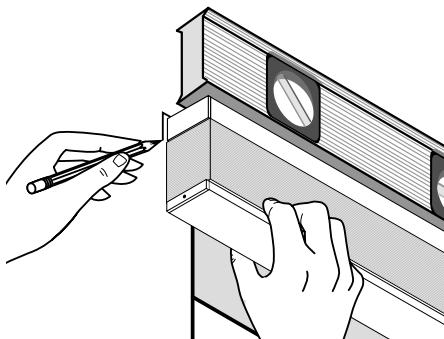

Optional Side Mount
 Montaje Lateral Opcional • Pose latérale (en option)

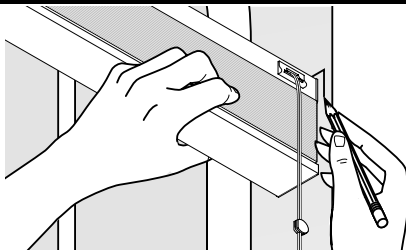
**4**

Measure in from shade edge on both ends and mark
 Mida desde el borde de la persiana en ambos extremos y marque
 Mesurer depuis le bord du store à chaque extrémité, et marquer

Inside/Ceiling Mount
 Montaje de Techo/Interior • Pose intérieure/au plafond

3"
 7,6 cm

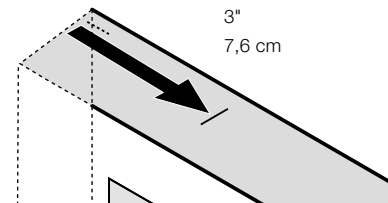

Outside Mount
 Montaje Exterior • Pose extérieure

3"
 7,6 cm

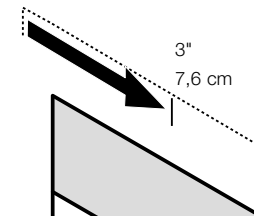
**5**

Mark screw locations; center additional brackets, if applicable
 Marque la ubicación de los tornillos; centre los soportes adicionales, si es aplicable
 Marquer l'emplacement des vis ; centrer les supports supplémentaires, le cas échéant

Inside/Ceiling Mount
 Montaje de Techo/Interior • Pose intérieure/au plafond

9/16"
 1,4cm

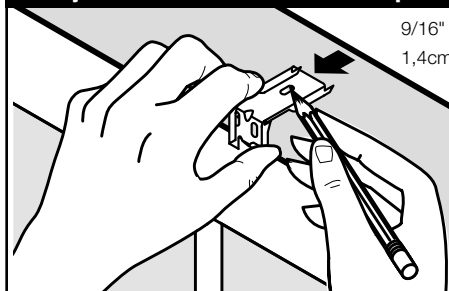

9/16" to front of bracket for flush mount
 1,4 cm desde el frente del soporte para un montaje a ras
 1,4 cm jusqu'à l'avant du support pour montage encastré

Outside Mount
 Montaje Exterior • Pose extérieure

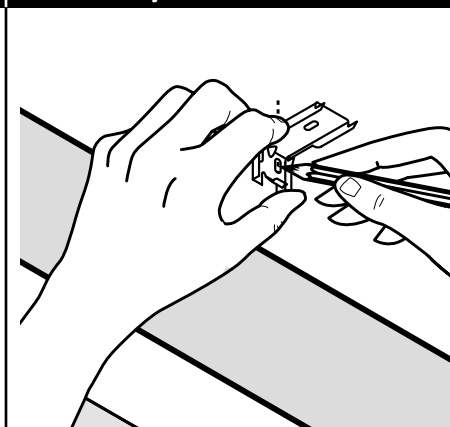

Optional Side Mount
 Montaje Lateral Opcional • Pose latérale (en option)

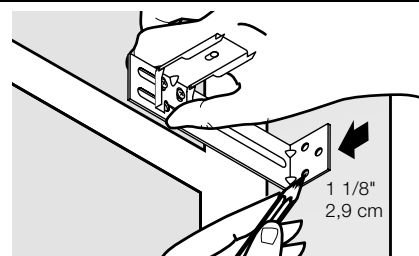

1 1/8" to front of bracket for flush mount
 2,9 cm desde el frente del soporte para un montaje a ras
 2,9 cm jusqu'à l'avant du support pour montage encastré

Optional Extension Bracket
 Soporte de Extensión Opcional • Rallonge (en option)

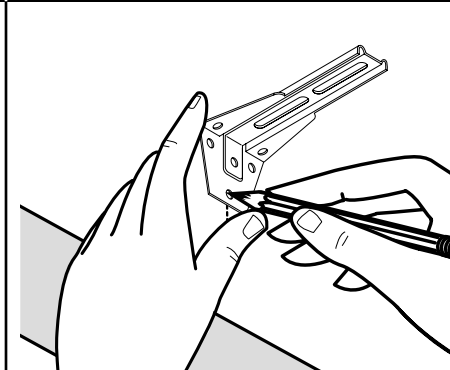

6

Drill holes
Taladre los agujeros
Perçer les trous

Inside/Ceiling Mount
Montaje de Techo/Interior • Pose intérieure/au plafond

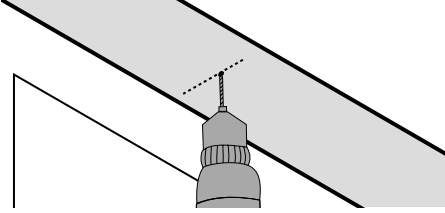

Outside Mount
Montaje Exterior • Pose extérieure

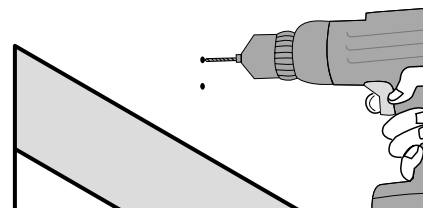

Optional Side Mount
Montaje Lateral Opcional • Pose latérale (en option)

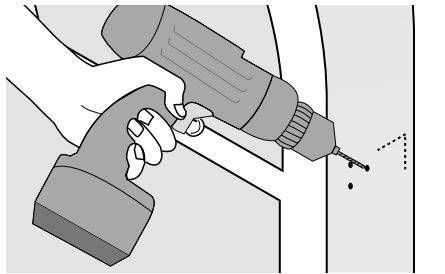

Optional Extension Bracket
Soporte de Extensión Opcional • Rallonge (en option)

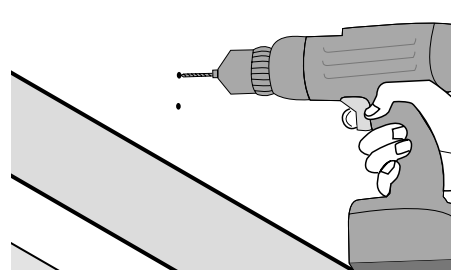
**7**

Screw brackets into place
Atornille los soportes en su lugar
Visser les supports

Inside/Ceiling Mount
Montaje de Techo/Interior • Pose intérieure/au plafond

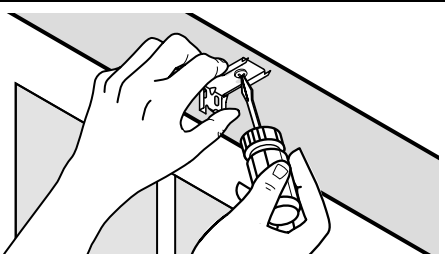

Outside Mount
Montaje Exterior • Pose extérieure

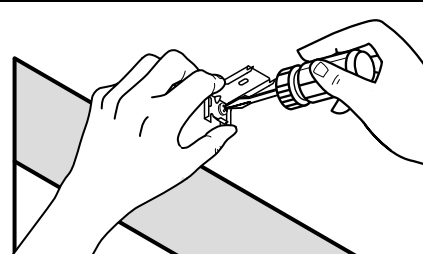

Optional Side Mount
Montaje Lateral Opcional • Pose latérale (en option)

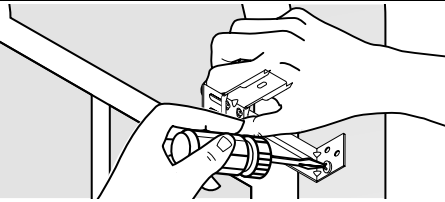

Optional Extension Bracket
Soporte de Extensión Opcional • Rallonge (en option)

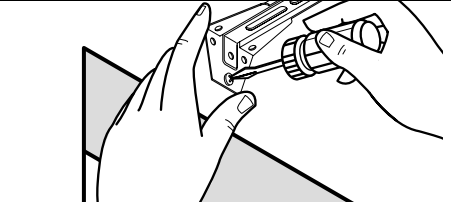
**7**

Optional extension brackets: assemble brackets
Soportes de extensión opcionales: ensamble los soportes
Rallonges en option : assembler les supports

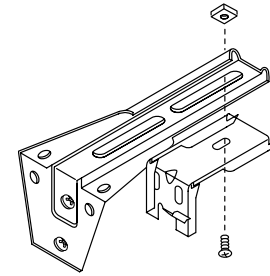

Attach headrail brackets to extension brackets using machine screws and nuts.
 Conecte los soportes del cabezal a los soportes de extensión usando tornillos y tuercas.
 Fixer les supports de boîtier aux rallonges à l'aide des vis et boulons de mécanique.

8

Mount shade into brackets
Monte la persiana en los soportes
Monter le store sur les supports

Inside/Ceiling Mount
Montaje de Techo/Interior • Pose intérieure/au plafond

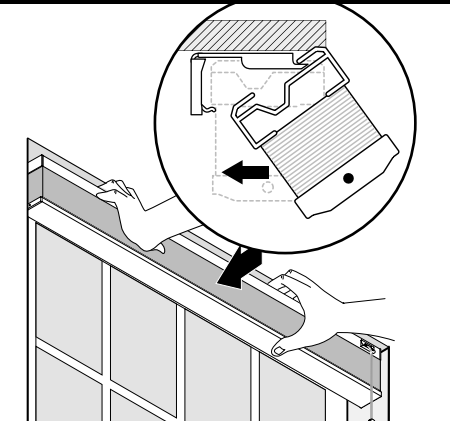

Outside Mount
Montaje Exterior • Pose extérieure

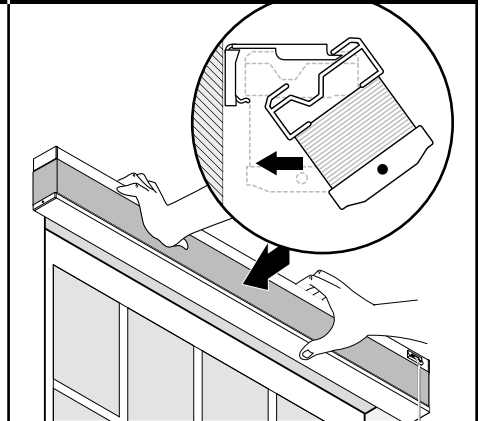

Optional Side Mount
Montaje Lateral Opcional • Pose latérale (en option)

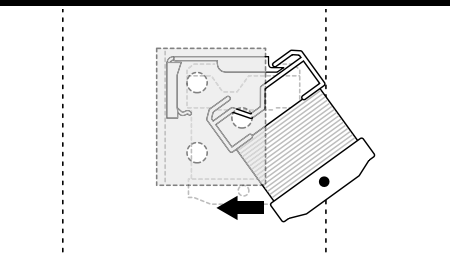

Optional Extension Bracket
Soporte de Extensión Opcional • Rallonge (en option)

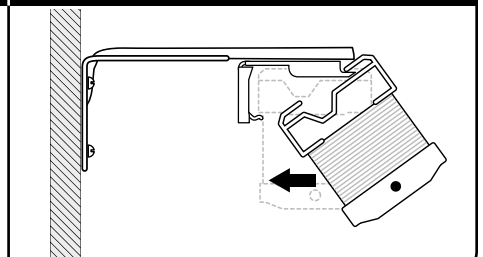

9

Important shade operating information: cord cleats
Importante información para la operación de la persiana: sostenedores de cuerda
Information importante relative à l'emploi du store : taquets de cordon

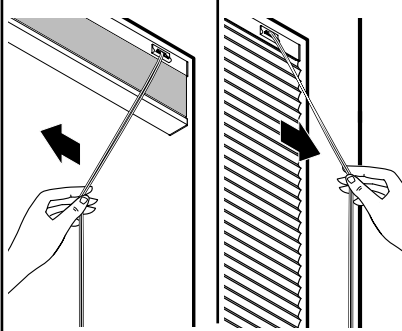

Pull the cords toward the center to lower shade to desired position. Pull toward the outside edge to lock the shade.

Jale las cuerdas hacia el centro para bajar la persiana hasta la posición más baja deseada. Jale hacia el extremo exterior para enlavar la persiana.

Tirer les cordons vers le centre pour baisser le store dans la position désirée la plus basse. Tirer vers l'extérieur pour bloquer le store.

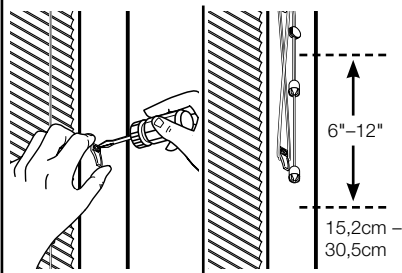

Install cord cleats and wrap cords in a figure eight to secure.

Instale los sostenedores de la cuerda; amarre las cuerdas en la forma de un ocho para asegurarla.

Installer les taquets du cordon ; enrouler les cordons en 8 pour les arrimer.



Shade length adjustment
Ajuste de la longitud de la persiana
Réglage de la longueur du store

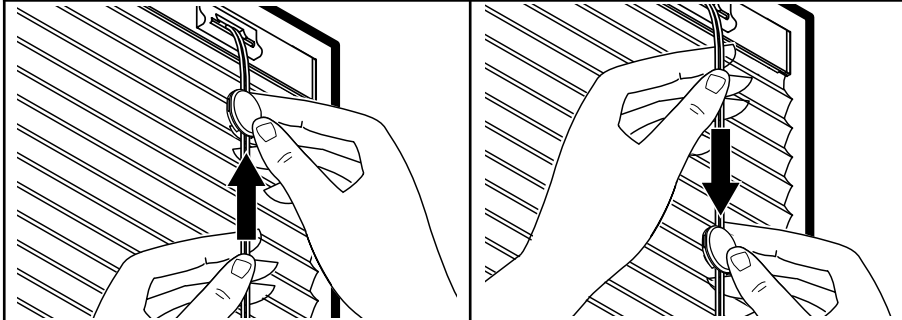

If Cellular Shade length adjustment is necessary, allow to hang for 24 hours at full extension. To adjust shade, firmly hold cords and slide snap tassel up to shorten or down to lengthen.

Si se necesita un ajuste de la longitud de la persiana celular, permita que cuelgue por 24 horas totalmente extendida. Para ajustar la persiana, sostenga firmemente las cuerdas y deslice las borlas para acortar o baje para alargar.

Si un réglage de la longueur du store s'avère nécessaire, le laisser pendre en pleine extension pendant 24 heures. Pour régler le store, tenir les cordons fermement et faire glisser le gland pression vers le haut pour raccourcir ou vers le bas pour allonger.



Shade removal
Remoción de la Persiana
Enlèvement du store

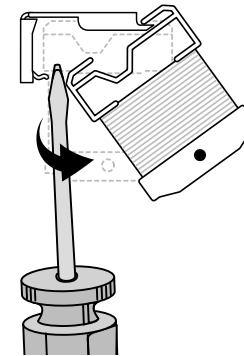

Optional: mount hold-down brackets
Opcional: monte los soportes para los sostenedores inferiores
En option : installer les supports de retenue

Inside/Ceiling Mount
Montaje de Techo/Interior • Pose intérieure/au plafond

Outside Mount
Montaje Exterior • Pose extérieure

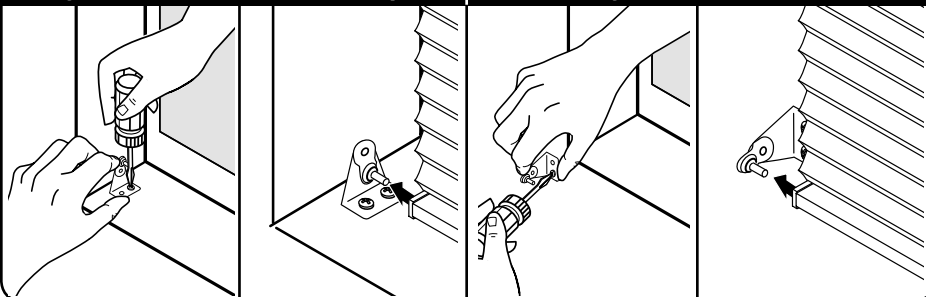

Thank you for purchasing this fine window treatment proudly constructed by us. Your shade has been custom-sized to your personal specifications with the highest standards of quality and craftsmanship. We have confidence that it will provide you with many years of beauty and easy maintenance. Enjoy!

Follow the easy step-by-step instructions to install your shade. Should you need additional support, please feel free to call our Customer Service Center at 1-800-221-6352 or email us at windowfashions@springswindowfashions.com. We will be glad to help you.

Again, we appreciate that you have chosen us to enhance the design and look of your home.

Gracias por adquirir este fino tratamiento de ventana orgullosamente fabricado para usted. Su persiana ha sido hecha a la medida del cliente según sus especificaciones personales con los más altos estándares de calidad y trabajo artesanal. Nosotros tenemos la confianza que le proveerá muchos años de belleza y fácil mantenimiento. ¡Disfrútelas!

Siga las fáciles instrucciones "paso a paso" para instalar su persiana. Si necesita ayuda adicional, favor de proceder con toda libertad llamando al Centro de Servicio al Cliente al teléfono 1-800-221-6352 o enviando un correo electrónico a windowfashions@springswindowfashions.com. Estaremos muy dispuestos para ayudarle.

Nuevamente, nosotros apreciamos que nos haya escogido para mejorar el diseño y la apariencia de su hogar.

Merci d'avoir acheté ce superbe traitement de fenêtre que nous sommes fiers d'avoir exécuté pour vous. Votre store a été fait sur mesure selon votre propre cahier des charges dans un souci d'excellence et de la plus haute technicité. Nous ne doutons pas qu'il vous offrira des années de beauté et d'entretien facile. Profitez-en bien!

Pour installer votre store, veuillez suivre les instructions détaillées. Si vous avez des questions n'hésitez pas à prendre contact avec notre Centre de service après-vente en téléphonant au 1-800-221-6352 ou par courrier électronique au windowfashions@springswindowfashions.com. Nous vous aiderons avec plaisir.

Encore une fois, nous vous remercions de nous avoir choisi pour améliorer et embellir votre intérieur.



Finished looks

Apariencia final

Aspects finis

Product design is protected by the following patents;
El diseño del producto está protegido por las siguientes patentes:
La conception du produit est protégée par les brevets suivants :
7,143,802 and/y/et 7,546,866

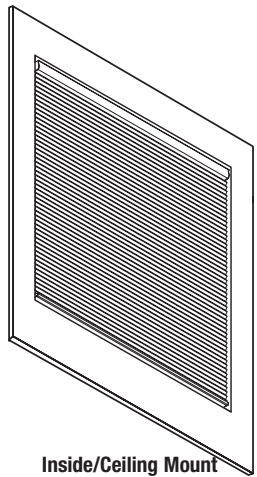

Inside/Ceiling Mount
Montaje de Techo/Interior
Pose intérieure/au plafond

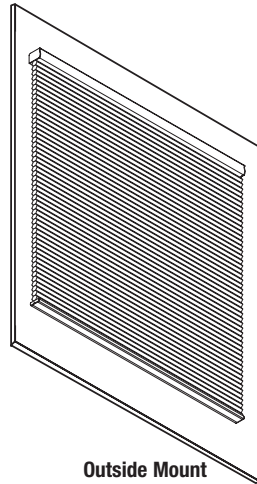

Outside Mount
Montaje Exterior
Pose extérieure

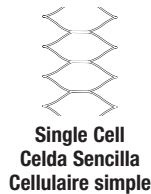

Single Cell
Celda Sencilla
Cellulaire simple

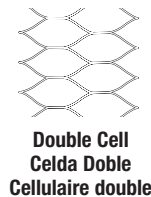

Double Cell
Celda Doble
Cellulaire double



Pleated
Plisada
Plissé



HOW TO INSTALL CÓMO INSTALAR COMMENT INSTALLER

Inside-/Ceiling- or Outside-mount Cordless Cellular or Pleated Shade

Persiana de tela Celular o Plisada sin cordón de instalación empotrada/en el techo o exterior

Store cellulaire ou plissé sans cordon à montage intérieur/au plafond ou extérieur

1

Everything needed to install your blind

Todo lo necesario para instalar su persiana

Tout le nécessaire pour la pose d'un store

- 1 Shade
- 2 Brackets/Screws
- 3 Cordless Handle(s)
- 4 Optional Hold-down Brackets
- 5 Optional Extension Brackets
- 6 Optional Side-mount Brackets

- 1 Persiana
- 2 Soportes/Tornillos
- 3 Asidera(s) Sin cordón
- 4 Soportes Sostenedores Inferiores Opcionales
- 5 Soportes de Extensión Opcionales
- 6 Soportes de Montaje Lateral Opcionales

- 1 Store
- 2 Supports/Vis
- 3 Poignée(s)
- 4 Supports de retenue (en option)
- 5 Rallonges (en option)
- 6 Supports pour pose latérale (en option)

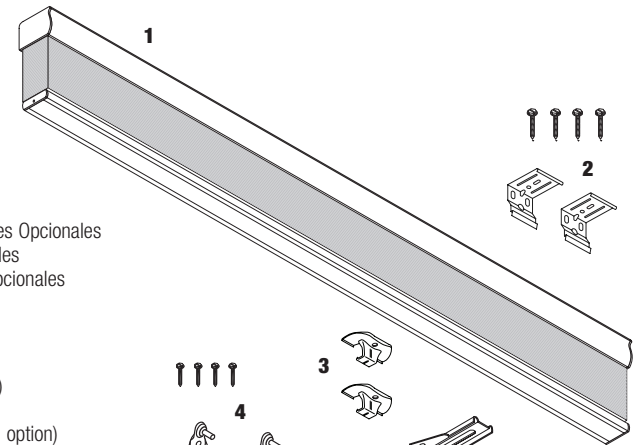

Bracket Chart Tabla de Soportes Tableau des supports

Ordered Width Ancho ordenado Largeur commandée	Bracket Qty. Cantidad de soportes Quantité de boîtier
≤ 42" ≤ 106,7 cm	2
≤ 72" ≤ 184,9 cm	3
≤ 102" ≤ 259 cm	4
≤ 132" ≤ 335,2 cm	5
≤ 144" ≤ 365,8 cm	6

Tools Needed • Herramientas Necesarias • Outils Nécessaire



1/16" drill bit
Broca de 1,6 mm
Mèche de 1,6 mm

2

Determine inside/ceiling, outside or side mount
 Determine el montaje de techo/interior, exterior o montaje lateral
 Choisir la pose intérieure/au plafond, extérieure ou latérale

2

Optional side mount for shades 60" or less: assemble brackets
 Montaje lateral opcional para persianas de 152,4 cm o menores: ensamble los soportes
 Pose latérale en option pour stores de 152,4 cm ou moins : assembler les supports

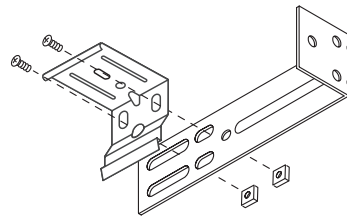
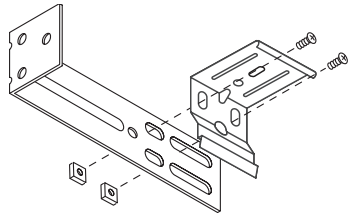
**3**

Place shade in desired location, mark corners
 Coloque la persiana en la ubicación deseada, marque las esquinas
 Placer le store dans l'emplacement souhaité, marquer les coins

Inside/Ceiling Mount
 Montaje de Techo/Interior • Pose intérieure/au plafond

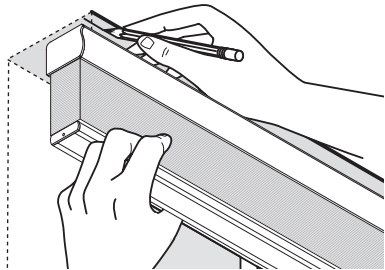

Outside Mount
 Montaje Exterior • Pose extérieure

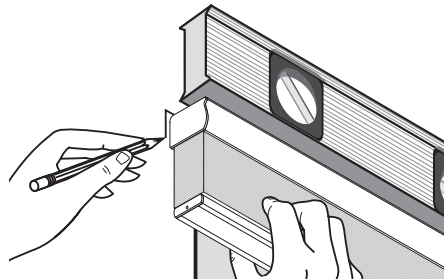

Optional Side Mount
 Montaje Lateral Opcional • Pose latérale (en option)

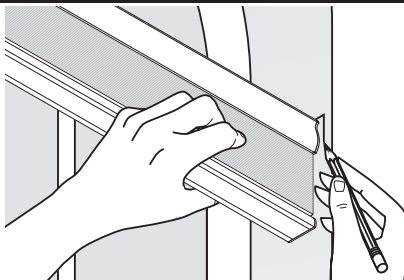
**4**

Measure in from shade edge on both ends and mark
 Mida desde el borde de la persiana en ambos extremos y marque
 Mesurer depuis le bord du store à chaque extrémité, et marquer

Inside/Ceiling Mount
 Montaje de Techo/Interior • Pose intérieure/au plafond

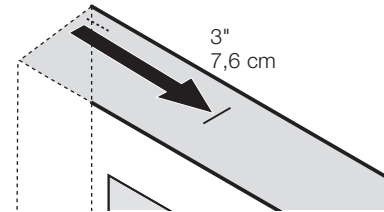

Outside Mount
 Montaje Exterior • Pose extérieure

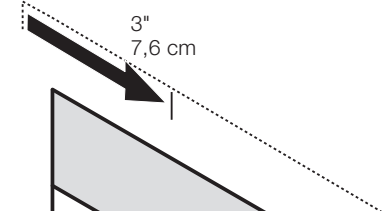
**5**

Mark screw locations; center additional brackets, if applicable
 Marque la ubicación de los tornillos; centre los soportes adicionales, si es aplicable
 Marquer l'emplacement des vis ; centrer les supports supplémentaires, le cas échéant

Inside/Ceiling Mount
 Montaje de Techo/Interior • Pose intérieure/au plafond

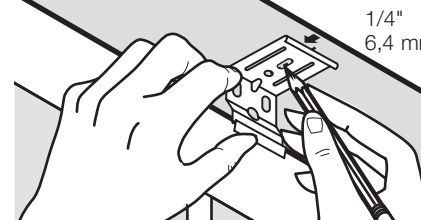

1/4" to front of bracket for flush mount
 6,4 mm desde el frente del soporte para un montaje a ras
 6,4 mm jusqu'à l'avant du support pour montage encastré

Outside Mount
 Montaje Exterior • Pose extérieure

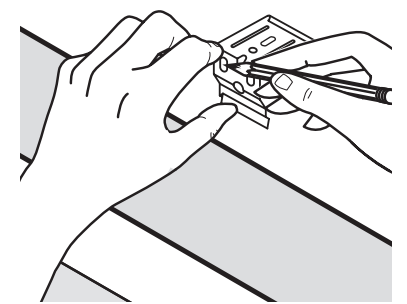

Optional Side Mount
 Montaje Lateral Opcional • Pose latérale (en option)

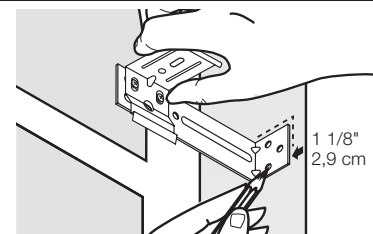

1 1/8" to front of bracket for flush mount
 2,9 cm desde el frente del soporte para un montaje a ras
 2,9 cm jusqu'à l'avant du support pour montage encastré

Optional Extension Bracket
 Soporte de Extensión Opcional • Rallonge (en option)

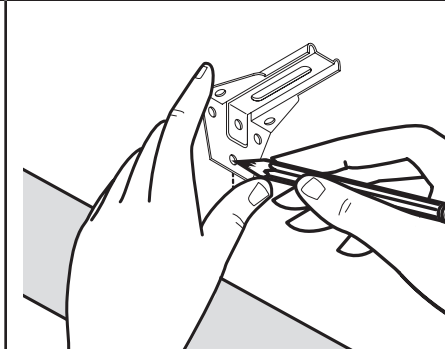

6

Drill holes
Taladre los agujeros
Percer les trous

Inside/Ceiling Mount
Montaje de Techo/Interior • Pose intérieure/au plafond

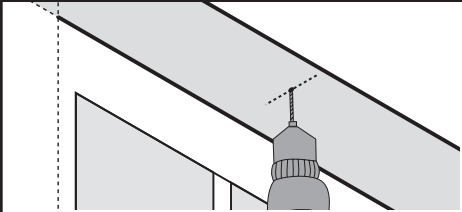

Outside Mount
Montaje Exterior • Pose extérieure

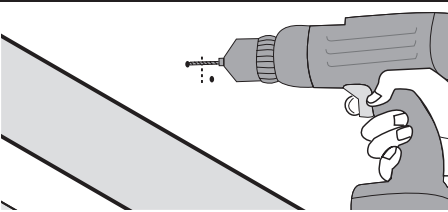

Optional Side Mount
Montaje Lateral Opcional • Pose latérale (en option)

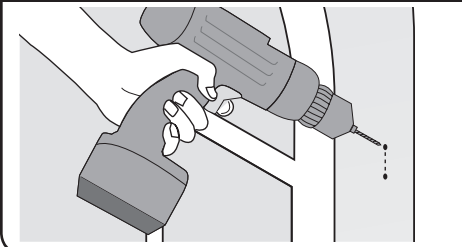

Optional Extension Bracket
Soporte de Extensión Opcional • Rallonge (en option)

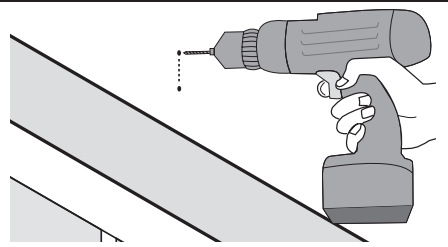

7

Screw brackets into place
Atornille los soportes en su lugar
Visser les supports

Inside/Ceiling Mount
Montaje de Techo/Interior • Pose intérieure/au plafond

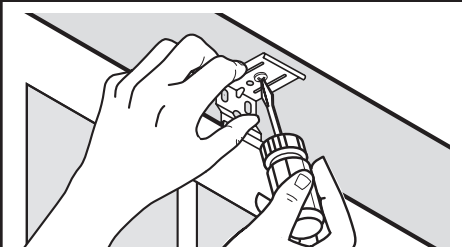

Outside Mount
Montaje Exterior • Pose extérieure

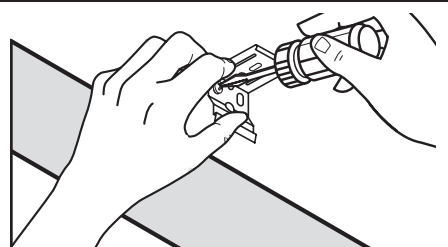

Optional Side Mount
Montaje Lateral Opcional • Pose latérale (en option)

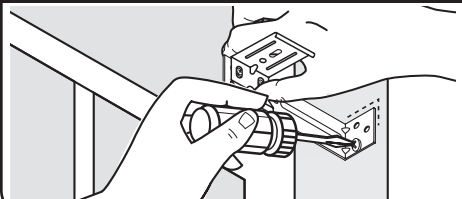

Optional Extension Bracket
Soporte de Extensión Opcional • Rallonge (en option)

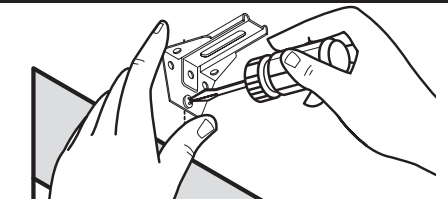

7

Optional extension brackets: assemble brackets
Soportes de extensión opcionales: ensamble los soportes
Rallonges en option : assembler les supports

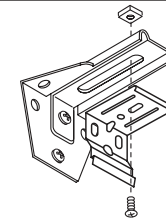

Attach headrail brackets to extension brackets using screws and nuts.
Conecte los soportes del cabezal con los soportes de extensión utilizando tornillos y tuercas.
Fixer les supports de boîtier aux rallonges à l'aide des vis et des écrous.

8

Mount shade into brackets
Monte la persiana en los soportes
Monter le store sur les supports

Inside/Ceiling Mount
Montaje de Techo/Interior • Pose intérieure/au plafond

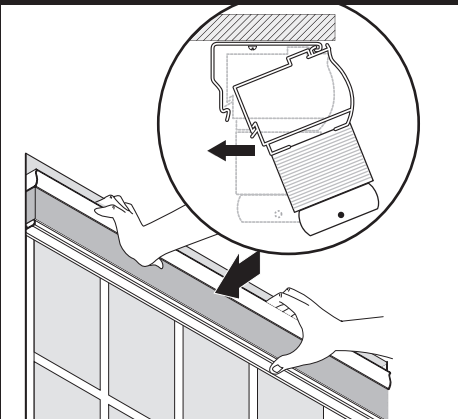

Outside Mount
Montaje Exterior • Pose extérieure

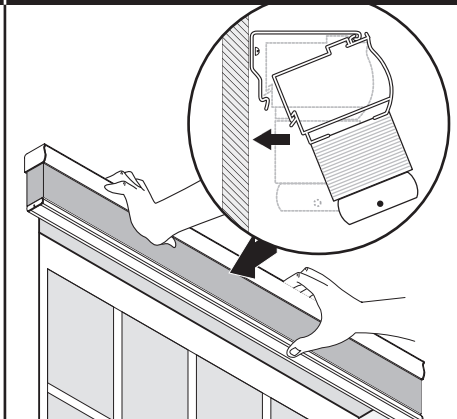

Optional Side Mount
Montaje Lateral Opcional • Pose latérale (en option)

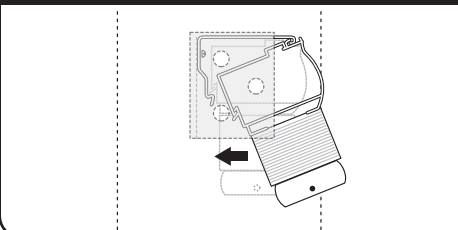

Optional Extension Bracket
Soporte de Extensión Opcional • Rallonge (en option)

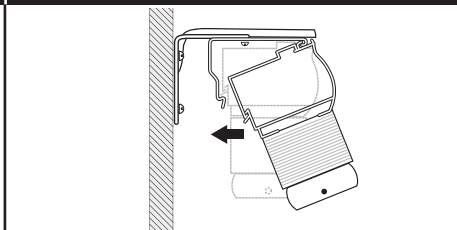

9

Attach cordless handle(s)
Conecte las asideras sin cordón
Fixer la ou les poignée(s)

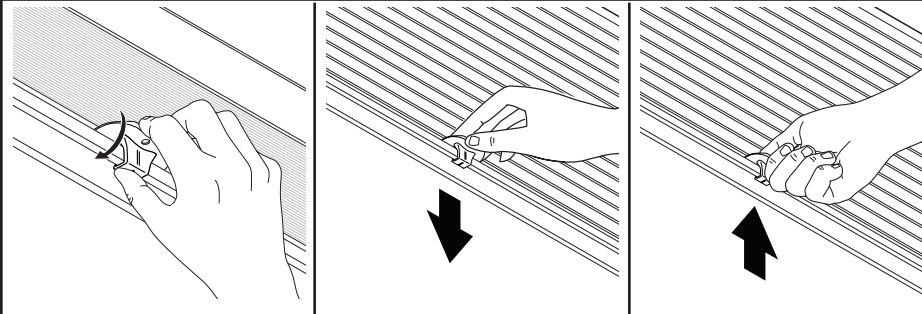

Clip handle to center of bottomrail, do not pinch fabric or slat. For shades over 48" wide (over 52" pleated), attach two handles, spaced evenly apart. For very wide shades, place handles as far apart as you comfortably can reach. To lower shade, use handle(s) to pull down. To raise shade, use handle(s) to lift up.

Sujete la manija en el centro del riel inferior sin perforar la tela ni la tablilla. En las persianas de más de 121.9 cm de ancho (más de 132.1 cm en el caso de las persianas plisadas), coloque dos manijas espaciadas de manera uniforme. En las persianas muy anchas, coloque las manijas a una distancia de separación que usted pueda alcanzar fácilmente. Para bajar la persiana, utilice la(s) manija(s). Para subir la persiana, utilice la(s) manija(s).

Fixez la poignée au centre du rail inférieur, ne coincez pas le tissu ou la latte. Pour les stores de plus de 121,9 cm de largeur (plus de 132,1 cm plissé), fixez deux poignées également espacées. Pour les stores très larges, placez les poignées aussi éloignées l'une de l'autre que vous pouvez joindre confortablement. Pour abaisser le store, utilisez la (les) poignée(s) pour tirer vers le bas. Pour relever le store, utilisez la (les) poignée(s) pour tirer vers le haut.

Optional Bottom Up/Top Down, Sun Up/Sun Down, Combination Shade
Opcional tipo Abajo-Arriba/Arriba-Abajo • En option : Store à ouverture vers le haut/vers le bas

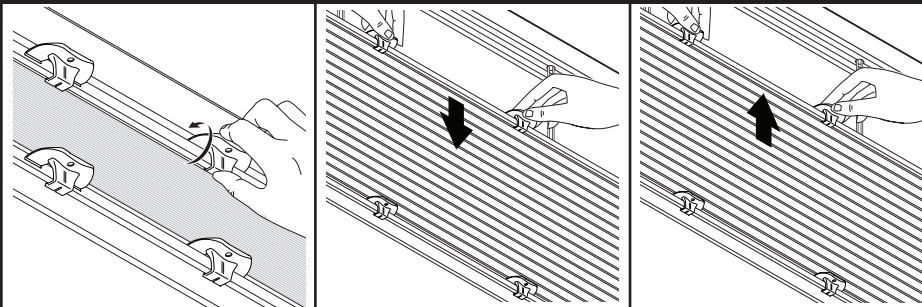

For optional bottom up/top down, sun up/sun down or combination shade, clip two handles to the middle rail and two handles to the bottomrail. To raise or lower shade, use both handles on each rail to pull up or down.

Para una persiana con opción de abajo hacia arriba/arriba hacia abajo, de doble tela/solar o una persiana combinada, conecte dos manijas en el riel del medio y dos manijas en el riel inferior. Para levantar o bajar la persiana, utilice ambas manijas de cada riel para tirar de la misma hacia arriba o hacia abajo.

Pour les stores à bas relevé/haut abaissé, lever du soleil/coucher du soleil ou combinaison en option, fixez deux poignées au rail du milieu et deux poignées au rail inférieur. Pour relever ou abaisser le store, utilisez les deux poignées sur chaque rail pour relever ou abaisser.



Optional: mount hold-down brackets
Opcional: monte los soportes para los sostenedores inferiores
En option : installer les supports de retenue

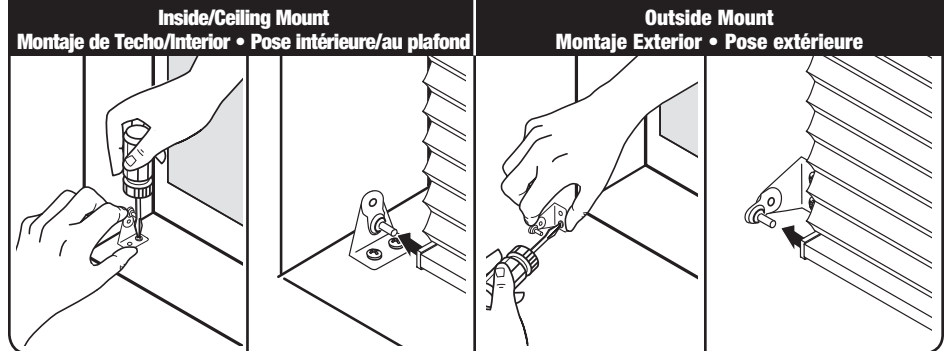

Shade removal
Remoción de la Persiana
Enlèvement du store

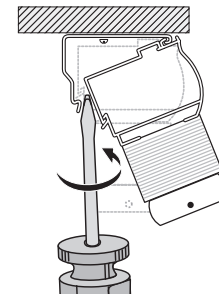

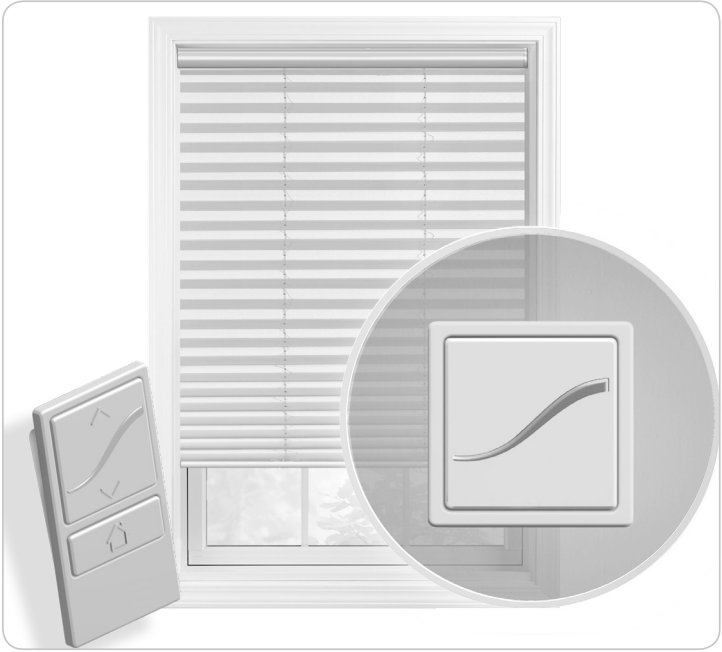

Owner's Manual

AutoView™ Motorized Shades

Table of Contents

About your Motorized Shade	2
Basic Shade Control	3
Control Features	3
Home Button - Single-Channel Remote	3
LED (Light) Locations and Battery Status	4
Program Buttons	5
Adjusting your Shade's Default Lower Limit (optional)	6
Adjusting your Shade's Default Upper Limit (optional)	6
Adjusting your Shade's Home Position (optional)	7
Adjusting the Home Position on a Group of Shades (optional)	8
Reversing Motor Direction	9
Adding Remotes and Creating Groups	10
Adding a New Remote When the Only Remote Controlling the Shade is Lost	10
Adding a New Remote as a Group Control	11
Adding Secondary Remotes to a Group of Shades for Individual Control Using a Single-Channel Remote as Primary ...	12
Reassigning a Two-Button Remote as a Group Control	13
Adding Secondary Remotes to a Group of Shades for Individual control Using a Two-Button Remote as Primary	14
Network Reset	15
Factory Limits Reset	15
Local Reset	15
Z-Wave Information	16
FCC Class B Notice	16

Please be sure to read and remove the securing tape and label before operating your motorized shade.

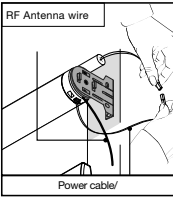

**A. Solar, Roller,
Artisan Fabric, Woven Wood**

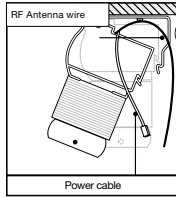

**B. Cellular, Pleated,
Classic Roman**

Remove securing tape and position motor RF antenna wire and power cable away from roller tube (see A) or outside of headrail (see B) depending upon product type.

Avoid crimping or damaging the antenna and power lead during installation process.

NOTE: RF antenna should be visible (exposed outside headrail) for greatest RF range. In some cases, RF antenna wire may need to be repositioned for optimal performance.

ATTENTION! IMPORTANT INSTALLATION INFORMATION
¡ATENCIÓN! INFORMACIÓN IMPORTANTE SOBRE LA INSTALACIÓN

About Your Motorized Shade

Motorized shades offer a convenient solution to everyday challenges. They provide instant privacy, glare reduction, and eliminate the need to manually adjust shades. Motorized shades also eliminate dangerous cords and create a comfortable and energy efficient environment. Your shades feature Z-Wave Radio technology, Z-Wave is an advanced radio platform which operates up to 65 ft and eliminates the need to aim the remote at the shade.

Basic Shade Control

Upon first power up, you will see a green light illuminate on the headrail or motor end of the shade. This will happen whenever power is first applied or restored after an outage. Press the UP or DOWN button to operate the shade.

Note: you can press and release the opposite directional button to stop the shade while it is in motion.



Press and release the UP button to fully open the motorized shade.



Press and release the DOWN button to fully close the motorized shade.

Momentary Movement: Press and hold the directional buttons (UP or DOWN) to operate shade. Releasing the directional button will stop the movement.

Control Features

Operating your shade with the two-button remote or optional single-channel remote.



Your controls have been pre-programmed to control your shade. The upper and lower limits and position have already been set. If you are not satisfied with the default upper, lower, or  position of your shade, see steps in the following sections of this manual.



UP Button

DOWN Button



HOME Button
(Intermediate/favorite)



Home Button – Single-Channel Remote



 button: Acts as a STOP button while shade is in motion. It can also be programmed as a quick way to bring shades to your preferred intermediate position.

Press and release  while your shade is at rest will bring your shade to your  position.

Press and release  while the shade is in motion will stop the shade.

Remote LED Indications

If the battery within the remote is completely discharged, there will be no LED feedback when a button is pressed. Always replace battery as a first solution if the LED does not light with a button press.

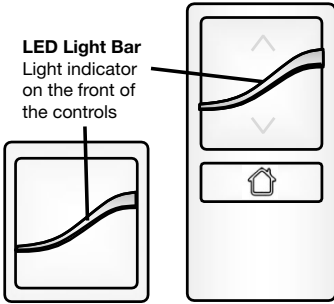

LED Action	When	Definition
Green flashing only	After button press	Remote battery is good
Amber flash after green flash sequence	After button press	Remote battery is low
Red flash after green flash sequence	After button press	Remote battery require replacement

Replacement battery: #CR2430

Shade LED Indications

The shade LED is located on the end of your shade and provides additional valuable feedback. Avoid excessively bright conditions for better visibility. If there is no operation or LED indication when a command is sent to the shade motor, replace the batteries to resolve.

LED Action	When	Definition
Amber flashing	After motor operation	Shade batteries are at ~ 20%
Red flashing	After motor operation	Shade batteries require replacement

Replacement batteries: 8AA Lithium per battery case; larger shades may require multiple battery cases

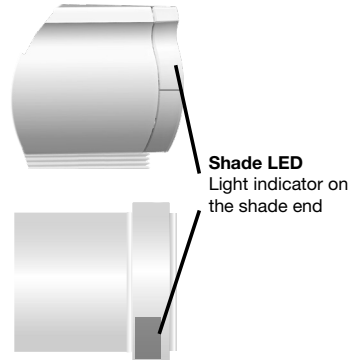

Program Button (remote)

The recessed button on the back of the two-button or optional single-channel remote which is used for various programming functions outlined in this guide.

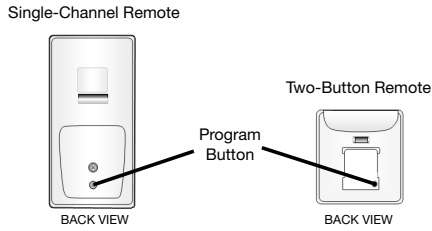

Program/Operation Button (shade)

The button located on the headrail or motor end. This button can be used to operate the shade if the remote is misplaced or to confirm various programming functions.

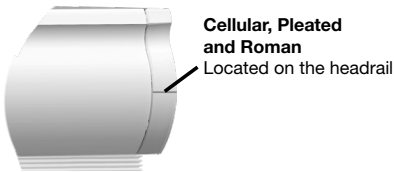

Adjusting Your Shade's Default Lower Limit (optional)

The lower limit of your shade is factory pre-set to a closed position matching the ordered length. You may want to adjust the lower limit to accommodate window hardware or other obstructions.

Note: a jog is a brief up and down movement of the shade.

- 

1. Press and release DOWN button. Allow the shade to reach its default lower limit.
- 

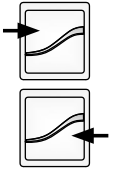
2. Once the shade stops, press and hold UP and DOWN buttons simultaneously until LED light on the remote turns amber (about 3 seconds) and release both buttons. The shade will jog and the LED on the remote will flash green. The LED on the shade will alternately flash green and red.
- 

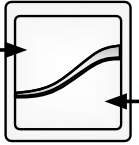
3. Adjust your lower limit by using UP or DOWN to move your shade to your desired lower limit.* The shade will only move while UP or DOWN is being pressed.
- 

4. When the shade is stopped at your new desired lower limit, press and hold UP and DOWN buttons simultaneously until the LED on the remote turns amber (about 3 seconds) then release both buttons. The shade will jog and the new lower limit is set.



***PRODUCT SAFETY NOTE:** Be careful not to exceed the ordered product length, this may result in damaged product. If your shade will not lower to your desired lower limit, contact a customer service agent for assistance.

NOTE: All programming steps are associated with a time-out feature to preserve battery life.

Adjusting Your Shade's Default Upper Limit (optional)

The upper limit of your shade is factory pre-set to an open position which protects the shade from damage while maximizing view. If you desire the shade to have an upper limit at a lower position when fully opened, follow these steps.

Note: a jog is a brief up and down movement of the shade.

- 

1. Press and release UP button. Allow the shade to reach its default upper limit.
- 

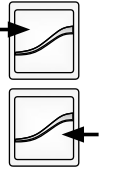
2. Once the shade stops, press and hold UP and DOWN buttons simultaneously until LED light on the remote turns amber (about 3 seconds) and release both buttons. The shade will jog and the LED on the remote will flash green. The LED on the shade will alternately flash green and red.
- 

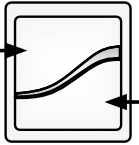
3. Adjust your upper limit by using UP or DOWN to move your shade to your desired upper limit.* The shade will only move while UP or DOWN is being pressed.
- 



4. When the shade is stopped at your new desired upper limit, press and hold UP and DOWN buttons simultaneously until the LED on the remote turns amber (about 3 seconds) then release both buttons. The shade will jog and the new upper limit is set.



***PRODUCT SAFETY NOTE:** When adjusting the upper limit on cellular or pleated shades, do not raise the product too tight. Adjusting the product too tight can cause the motor to fail and/or break/fray the internal cording. When installing a solar or roller shade in a fascia or cassette valance, be sure the hembar does not lift into the fascia or cassette, as this could cause the hembar to get stuck and/or damage the fabric.



NOTE: All programming steps are associated with a time-out feature to preserve battery life.

Adjusting Your Shade's Home Position (optional)

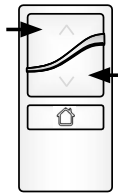
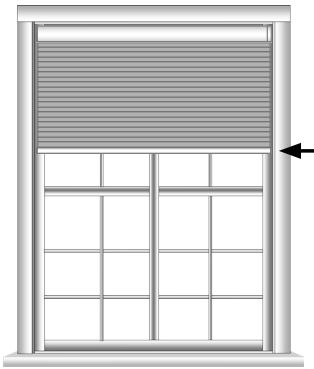

If your shade system includes an optional single-channel remote, it has been pre-programmed to control your shade(s). The default  position (intermediate position) is pre-set to mid-length of your shade. To change the  position, follow these steps.



Note: if the single-channel remote controls multiple shades as a group, refer to the next section.



1. Use the UP or DOWN button to put the shade in motion. When the shade reaches your desired  position, press and release  to stop the shade.





2. To set your  position, press and hold the  button until the LED on the remote turns amber (about 3 seconds), then release the button. The shade will jog and the new  position is set.

Note: Always adjust the upper and lower limits before adjusting your  position. After adjusting the upper or lower limits, the  position will reset to the new mid-length position.



A time-out can occur during programming the remote or motor, when no buttons are pressed within a predetermined amount of time. This remote or motor will revert back to a user state. Simply repeat programming steps if the remote or motor has timed-out.

Adjusting the Home Position on a Group of Shades (optional)

If your shade system includes an optional single-channel remote as a group control, it has been pre-programmed to control your shades. The default  position (intermediate position) of all shades is pre-set to mid-length. To change the  position on multiple shades, follow these steps.

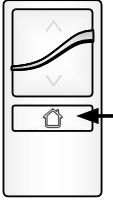

Fig. 1



Fig. 2

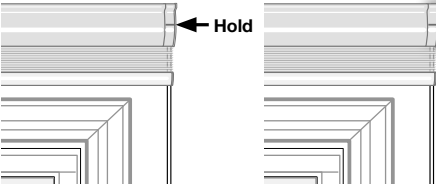

Fig. 3

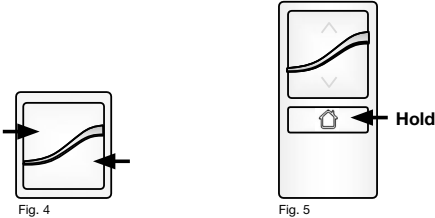

Fig. 4

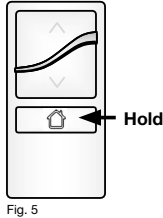
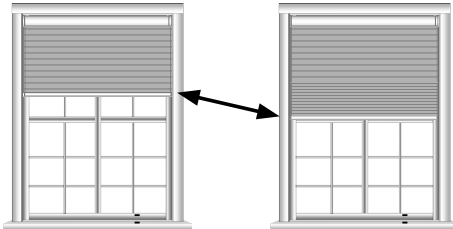







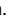

Fig. 5



1. Press and release the  button to bring the group of shades to their pre-programmed  position. (Fig. 1)
2. In order to adjust the  position of each shade, you must first target the individual shade you want to adjust. To do this, press and release the program button on the back of the single-channel remote (one tap). The LED on the remote will alternately flash green. (Fig 2)
3. Then on the shade that you want to adjust, press and hold the program button on the headrail/motor end until the LED begins to flash green (about 3 seconds) and release. The shade will jog. (Fig. 3)
4. Using the two-button remote that controls the shade, adjust the shade to the new desired position. (Fig. 4)
5. Using the single-channel remote, press and HOLD the  button until the LED turns amber (about 3 seconds) and release the button. The shade will jog and the  position of the target shade is now reset. (Fig. 5)
6. Repeat process for additional shades to adjust the new desired  position.

Notes:

- Always adjust the upper and lower limits before adjusting your  position. After adjusting the upper or lower limits, the  position will reset to the new mid-length position.
- You are required to access the motor head to adjust the  position.



A time-out can occur during programming the remote or motor, when no buttons are pressed within a predetermined amount of time. This remote or motor will revert back to a user state. Simply repeat programming steps if the remote or motor has timed-out.

Reversing Motor Direction

Each shade is pre-programmed from the factory to operate up and down corresponding to the appropriate buttons on your remote(s). However, if the directions are inadvertently reversed, follow these steps to return the shade to proper operation.

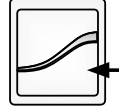
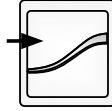
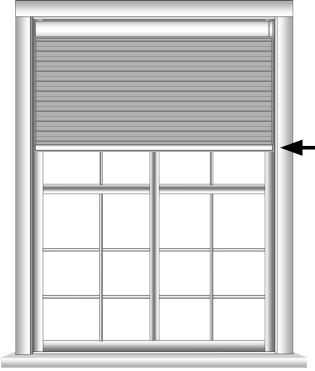

Fig. 1

1. Move the shade to a position between the upper and lower limits. Press and release a directional button to set the shade in motion. Press the opposite directional button to stop the shade. (Fig. 1)

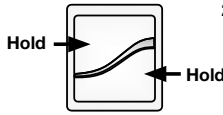

Fig. 2

2. Press and hold UP and DOWN buttons until the LED light turns amber (about 3 seconds) then release buttons. (Fig. 2)
The shade will jog and the LEDs on the motor will begin to flash green and red and the LEDs on the remote will flash green.



Fig. 3

3. Press and hold the UP and DOWN buttons until the LED turns amber (about 3 seconds) then release buttons. (Fig. 3)
Shade direction has now been reversed; however, the upper and lower limits have been maintained.



A time-out can occur during programming the remote or motor, when no buttons are pressed within a predetermined amount of time. This remote or motor will revert back to a user state. Simply repeat programming steps if the remote or motor has timed-out.

Adding Remotes and Creating Groups

Your motorized shades are pre-programmed from the factory with the appropriate pairing and grouping between remotes and shade motors. There are several scenarios when additional programming steps will be required. The next sections explain how to accomplish the most common scenarios you will encounter. If the appropriate scenario is not included, please contact a customer service representative prior to attempting any adjustments.

Adding a New Remote When the Only Remote Controlling the Shade is Lost

If you no longer have your remote, or the remote has been damaged and no longer works, follow these steps.

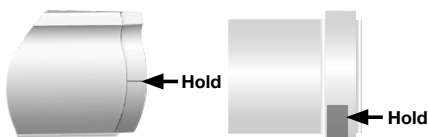

Fig. 1

1. Press and hold the program button on the headrail/motor end, the LED will flash green then amber (about 7 seconds). When the shade jogs once, release the button and the LED will turn solid amber and turn off. The motor is now ready to be associated to a new remote. (Fig. 1)

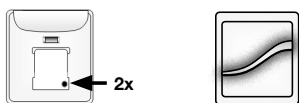

Fig. 2

2. Using a paper clip or a similar item, press and release the programming button located on the back side of the new remote twice in rapid succession (2 taps) The LED on the remote will flash alternately amber and green. (Fig. 2)

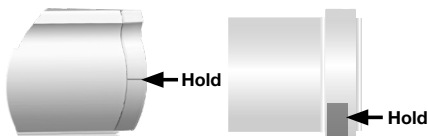

Fig. 3

3. Press and hold the program button on the headrail/motor end, release when LED flashes green (about 3 seconds). (Fig. 3.) The shade will jog and all LED's will turn off. The shade will now operate from the newly added remote.



A time-out can occur during programming the remote or motor, when no buttons are pressed within a predetermined amount of time. This remote or motor will revert back to a user state. Simply repeat programming steps if the remote or motor has timed-out.

Adding a New Single-Channel Remote as a Group Control

If a group control was not selected at the time of purchase and is being added to an existing motorized shade, follow the steps below.

Note: Individual shade control will be restored with the original two-button remote only after it has been reassociated with the shade as a secondary remote. (see next page).

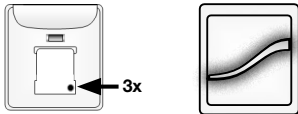

Fig. 1

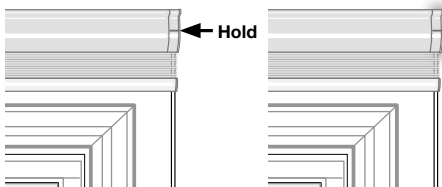

Fig. 2

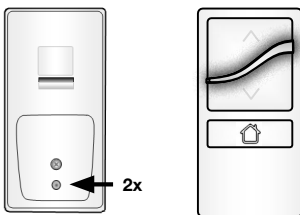

Fig. 3

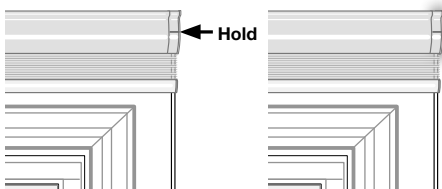

Fig. 4

1. Exclude the two-button remote as the primary control

A. Press and release the program button on the back of the remote three times in rapid succession (3 taps). The LED will flash, alternating amber to identify exclusion mode. (Fig. 1)

B. Press and hold the button on the headrail/motor end until the LED begins to flash green (about three seconds), and release. The LED on the motor will turn solid green, then turn off and the shade will jog, confirming exclusion. (Fig. 2)

2. Include the new group remote as the primary control.

A. Press and release the program button on the back of the remote twice in rapid succession (2 taps). (Fig. 3.) The LED on the new group remote will flash alternating amber and green to identify inclusion mode.

B. Press and hold the program button on the headrail/motor end until the LED flashes green (about 3 seconds), and release. (Fig. 4.) The shade will jog and all LED's will turn off. The shade will now operate from the newly added remote.

Repeat this process for each motor to be added to this group.

Go to page 12 to add secondary remotes to shades in the group for individual control.



A time-out can occur during programming the remote or motor, when no buttons are pressed within a predetermined amount of time. This remote or motor will revert back to a user state. Simply repeat programming steps if the remote or motor has timed-out.

Adding Secondary Remotes to a Group of Shades for Individual Control Using a Single-Channel Remote as Primary

Adding individual control to shades that are part of a newly formed group. This remote will now be referred to as the secondary control.

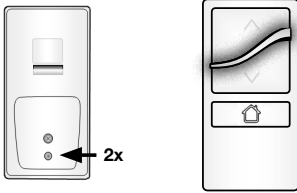

Fig. 1

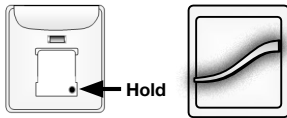

Fig. 2

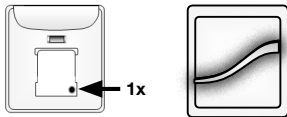

Fig. 3

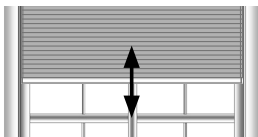
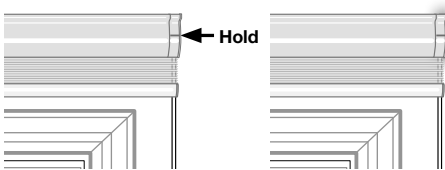

Fig. 4

1. Joining a secondary remote to the primary remote.

- A. Starting with the primary control, press and release the program button on the back side of the current remote twice in rapid succession (2 taps). The LED light will flash alternating amber and green to identify inclusion mode. (Fig. 1)
- B. Press and hold the program button on the secondary remote control until the LED light flashes green (about 3 seconds), then release the button. (Fig. 2.) Both the primary and secondary remote LEDs will flash green, then turn off confirming inclusion.

2. Associate secondary control to the motor.

- A. Press and release the program button on the back side of the secondary control once (1 tap). The LED will flash green. (Fig. 3)
- B. Press and hold the program button on the target shade headrail or motor end until the LED light flashes green (about 3 seconds), then release button. (Fig 4.) The LED on the secondary control will turn green and the shade will jog. Both the primary (group) and secondary (individual) controls will now operate the shade.

Repeat this process on all shades you want to individually control.

Reassigning a Two-Button Remote as a Group Control

This process is followed when the end user desires to reassign a two-button remote to control a group of shades. You must first exclude all individual two-button remotes and include the two-button remote you desire as the primary controller.

NOTE: This two-button remote will no longer perform as an individual motor controller.

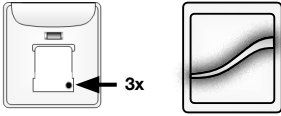

Fig. 1

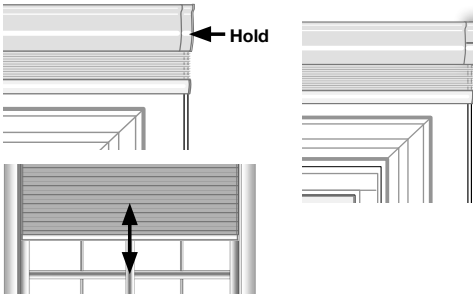

Fig. 2

1. Exclude the two-button remote as the primary control.

A. Press and release the program button on the back of the remote three times in rapid succession (3 taps). The LED will flash, alternating amber to identify exclusion mode. (Fig. 1)

B. Press and hold the button on the headrail/motor end until the LED begins to flash green (about three seconds), and release. The LED on the motor will turn solid green, then turn off and the shade will jog, confirming exclusion. (Fig. 2)

Repeat this process for each motor to be added to this group.

Go to page 14 to add secondary remotes to shades in the group for individual control.

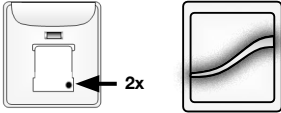

Fig. 3

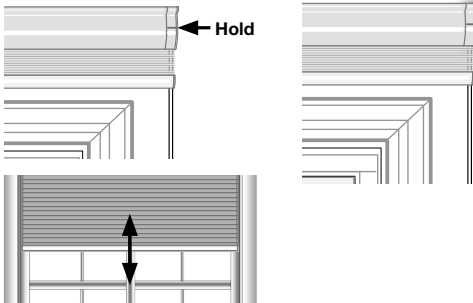

Fig. 4

2. Include two-button remote as the primary controller of a group of shades.

A. Press and release the program button on the back of the remote twice in rapid succession (2 taps). (Fig. 3.) The LED on the new group remote will flash alternately amber and green to identify inclusion mode.

B. Press and hold the program button on the headrail/motor end until the LED flashes green (about 3 seconds), and release. (Fig. 4.) The shade will jog and all LED's will turn off. The shade will now operate from the newly added remote.

Repeat this process for each motor to be added to this group.

Go to page 14 to add secondary remotes to shades in the group for individual control.

Adding Secondary Remotes to a Group of Shades for Individual Control Using a Two-Button Remote as Primary.

Adding individual control to shades that are part of a newly formed group. This remote will now be referred to as the secondary control.

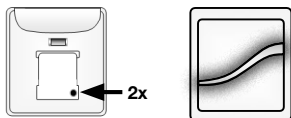

Fig. 1

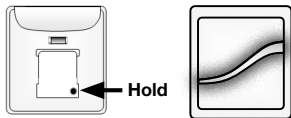

Fig. 2

1. Joining a secondary remote to the primary remote.

A. Starting with the primary control, press and release the program button on the back side of the current remote twice in rapid succession (2 taps). The LED light will flash alternating amber and green to identify inclusion mode. (Fig. 1)

B. Press and hold the program button on the secondary remote control until the LED light flash green (about 3 seconds), then release the button. (Fig. 2.) Both the primary and secondary remote LEDs will flash green, then turn off confirming inclusion.

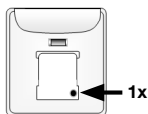

Fig. 3

2. Associate secondary control to the motor.

A. Press and release the program button on the back side of the secondary control once. The LED will flash green. (Fig. 3)

B. Press and hold the program button on the target shade headrail or motor end until the LED light flashes green (about 3 seconds), then release button. (Fig. 4.) The LED on the secondary control will turn green and the shade will jog. Both the primary (group) and secondary (individual) controls will now operate the shade.

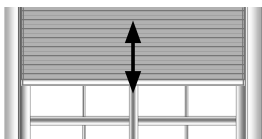
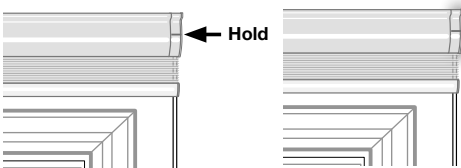
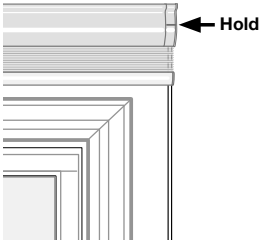

Fig. 4

Repeat this process on all shades you want to individually control.

Use these procedures only if a complete network reset is required.
Contact Customer Service to understand if you need to perform these steps.

Network Reset



1. Press and hold the button on the headrail endcap until the shade jogs once (about 7 seconds), then release the button. The LED will go from solid green, flashing green, and go to flashing amber.

NOTE: Shade limits are not lost. All controllers will be removed from the motor's memory.

Local Reset - Motor

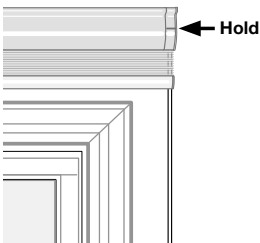

1. Press and hold the button on the headrail endcap until the shade jogs twice (about 15 seconds), then release the button. The LED will go from solid green, flashing green, to flashing amber then go to rapid flashing red.

NOTE: Factory limits are set in the motor at about 2" to 4" apart. All controllers will be removed from the motor's memory.

Local Reset - Remotes

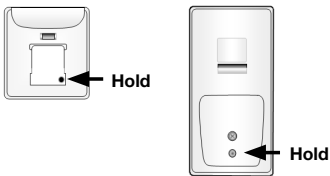

1. Press and hold the programming button until the LEDs stop flashing. LEDs will flash green, amber, red, and then finally turn off (about 15 seconds).

NOTE: Local reset must be performed on both the controllers and motors. All motors will be removed from the remotes memory



Z-Wave is a wireless mesh-networking protocol for reliable, intelligent home control of all Z-Wave compatible devices. Z-Wave devices can act as repeaters to create a mesh-network to ensure reliable communication regardless of the manufacturer or type of device. This product can be included and operated in any Z-Wave network with other Z-Wave certified devices from any other manufacturer. Z-Wave devices such as lamp modules, fan controllers, thermostats, dimmer switches and many other types of home control devices are available from a wide range of manufacturers. The Z-Wave Alliance (www.z-wavealliance.com) provides a list of manufacturers of Z-Wave compliant devices. Z-Wave was created by Sigma Designs and more details on the technology can be found at www.z-wave.com.

This product can be included and operated in any Z-Wave network with other Z-Wave certified devices from other manufacturers and/or other applications. All non-battery operated nodes within the network will act as repeaters regardless of vendor to increase reliability of the network.

The current product controls may establish 2 Association Groups. Association Group #1 is dedicated Lifeline for secondary controls, primarily used for battery status reports, central scene cc, local reset cc. Association Group #2 is dedicated to slave shades nodes, with a maximum of 12 slave nodes. Normal shade control command will use association group #2.

FCC Class B Notice

This device complies with Part 15 of the FCC Rules. Operation is subject to the following two conditions:

1. This device may not cause harmful interference.
2. This device must accept any interference received, including interference that may cause undesired operation.

Note: This equipment has been tested and found to comply with the limits for a Class B digital device, pursuant to Part 15 of the FCC Rules. These limits are designed to provide reasonable protection against harmful interference in a residential installation. This equipment generates, uses and can radiate radio frequency energy and, if not installed and used in accordance with the instructions, may cause harmful interference to radio communications. However, there is no guarantee that interference will not occur in a particular installation. If this equipment does cause harmful interference to radio or television reception, which can be determined by turning the equipment off and on, the user is encouraged to try to correct the interference by one or more of the following measures:

- Reorient or relocate the receiving antenna.
- Increase the separation between the equipment and receiver.
- Connect the equipment into an outlet on a circuit different from that to which the receiver is connected.
- Consult the dealer or an experienced radio/television technician for help.

Modifications: Any modifications made to this device that are not approved by Oracle may void the authority granted to the user by the FCC to operate this equipment.

Advance technical information can be found at the website mentioned below, or contacting customer service.

Bali is a brand of Springs Window Fashions, the Best Experience Company 

Visit us at: BaliBlinds.com

or contact motorization technical support at motorization.support@springswindowfashions.com

1-866-221-6352

your home, your style

79084-00 (05/16) IMR 16-2679
springswindowfashions.com • Middleton, WI 53562